

SHIMANO

STELLA

STL-5000FA

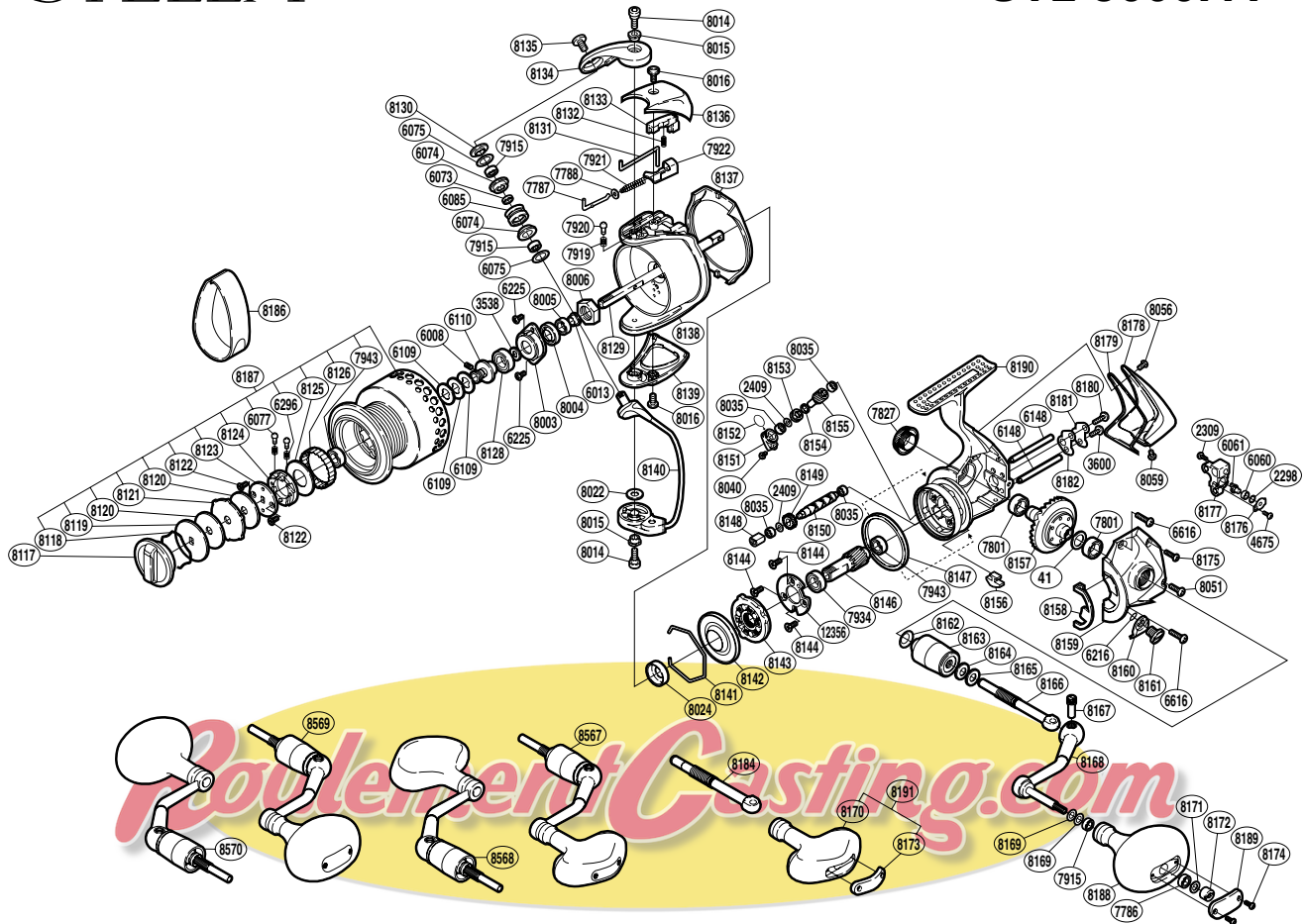

Part No.	Description	Part No.	Description	Part No.	Description
RD 0041	Drive Gear Washer	RD 8024	Rotor Ring	RD 8156	Bail Trip Strike
RD 2298	Spacer	RD 8035	Ball Bearing	RD 8157	Drive Gear
RD 2309	Slider Retainer Screw	RD 8040	Gear Cover Screw	RD 8158	Flange Water Proof
RD 2409	Worm Shaft Spacer	RD 8051	Side Cover Screw (B)	RD 8159	Side Cover
RD 3538	Spool Support	RD 8056	Protector Screw (C)	RD 8160	Oil Shield Cover
RD 3600	Worm Shaft Retainer Screw (B)	RD 8059	Protector Screw (D)	RD 8161	Oil Cap
RD 4675	Oscillating Pawl Cover Screw	RD 8117	Drag Knob	RD 8162	Handle Shaft Seal
RD 6008	Set Screw	RD 8118	Drag Washers Retainer	RD 8163	Handle Shaft Cover
RD 6013	Main Shaft Spacer	RD 8119	Key Washer	RD 8164	Disc Spring
RD 6060	Oscillating Slider Bushing	RD 8120	Drag Washer (A)	RD 8165	Large Handle Shank Washer
RD 6061	Oscillating Pawl	RD 8121	Eared Washer	RD 8166	Handle Shaft (Left)
RD 6073	Bearing Spacer	RD 8122	Drag Click Holder Cover Screw	RD 8167	Handle Shank Screw
RD 6074	Line Roller Bushing	RD 8123	Drag Click Holder Cover	RD 8168	Handle Shank Assembly
RD 6075	Roller Bearing Seal	RD 8124	Drag Click Holder	RD 8169	Handle Knob Adjust Washer
RD 6077	Click Pin	RD 8125	Drag Washer (B)	RD 8171	Handle Knob Adjust Washer
RD 6085	Line Roller	RD 8126	Drag Click Collar	RD 8172	Handle Knob Nut
RD 6109	Spool Washer	RD 8128	Ball Bearing	RD 8174	Handle Knob Screw
RD 6110	Bearing Bushing	RD 8129	Main Shaft	RD 8175	Side Cover Screw (C)
RD 6148	Oscillating Guide (B)	RD 8130	Line Roller Washer	RD 8176	Oscillating Pawl Cover
RD 6216	"O" Ring	RD 8131	Bail Trip Lever	RD 8177	Oscillating Slider
RD 6225	Nut Lock Screw	RD 8132	Bail Trip Cover Spring	RD 8178	Rear Protector
RD 6296	Click Spring	RD 8133	Bail Trip Cover	RD 8179	Rear Shield
RD 6616	Side Cover Screw (A)	RD 8134	Bail Arm	RD 8180	Worm Shaft Retainer Screw (A)
RD 7786	Ball Bearing	RD 8135	Line Roller Screw	RD 8181	Worm Shaft Retainer
RD 7787	Bail Spring Guide (A)	RD 8136	Bail Spring Cover	RD 8182	Worm Shaft Retainer Washer
RD 7788	Spring Guide (A) Support	RD 8137	Rotor Guard	RD 8187	Spool Assembly
RD 7801	Ball Bearing	RD 8138	Rotor	RD 8188	Handle Knob (Round type A)
RD 7827	Handle Screw Cap	RD 8139	Bail Hold Support Guard	RD 8189	Handle Knob I.D. Plate
RD 7915	Ball Bearing	RD 8140	Bail Assembly	RD 8190	Body
RD 7919	Click Spring	RD 8141	Roller Clutch Water Proof Retainer	RD12356	Bearing Retainer
RD 7920	Click Pin	RD 8142	Roller Clutch Water Proof		
RD 7921	Bail Spring	RD 8143	Roller Clutch Assembly		
RD 7922	Bail Spring Seat	RD 8144	Bearing Retainer Screw		
RD 7934	Ball Bearing	RD 8146	Pinion Gear	RD 8191	Handle Knob Assembly (T type A)
RD 7943	Ball Bearing	RD 8147	Friction Ring	RD 8567	Left Handle Assembly (T type A 4000)
RD 8003	Rotor Nut Lock Plate	RD 8148	Worm Bushing	RD 8568	Right Handle Assembly (T type A 4000)
RD 8004	Bearing Water Proof	RD 8149	Idle Gear	RD 8569	Left Handle Assembly (Round type A 4000)
RD 8005	Ball Bearing	RD 8150	Worm Shaft	RD 8570	Right Handle Assembly (Round type A 4000)
RD 8006	Rotor Nut	RD 8151	Gear Cover		
RD 8014	Bail Arm Screw	RD 8152	Gear Cover Seal	RD 8170	Spare Handle Knob (T type A)
RD 8015	Bail Arm Screw Collar	RD 8153	Idle Gear (B)	RD 8173	Spare Handle Knob I.D. Plate
RD 8016	Protector Screw (A)	RD 8154	Idle Gear Collar	RD 8184	Handle Shaft (Right)
RD 8022	Bail Hold Support Washer	RD 8155	Pinion Worm Gear	RD 8186	Line Band (L)