

# SHIMANO

## STELLA A-RB

## STL-10000FA

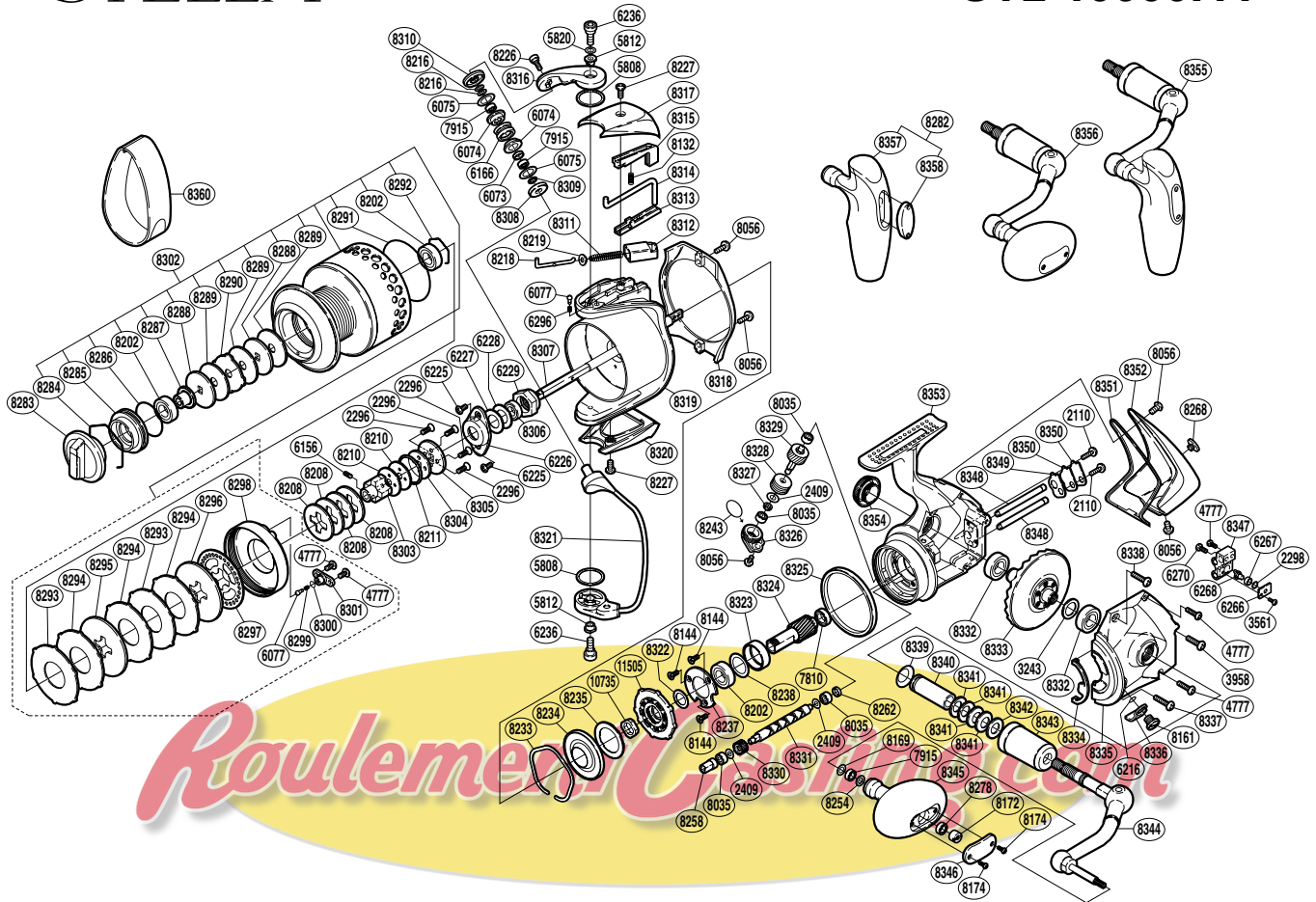

Part No.	Description	Part No.	Description	Part No.	Description
RD 2110	Worm Shaft Retainer Screw	RD 8227	Protector Screw	RD 8318	Rotor Guard
RD 2296	Support Lock Screw	RD 8233	Roller Clutch Water Proof Retainer	RD 8319	Rotor
RD 2298	Spacer	RD 8234	Roller Clutch Water Proof	RD 8320	Bail Hold Support Guard
RD 2409	Worm Shaft Spacer	RD 8235	Roller Clutch Reinforce	RD 8321	Bail Assembly
RD 3243	Drive Gear Washer	RD 8237	Bearing Retainer	RD 8322	Adjusting Washer
RD 3561	Oscillating Pawl Cover Screw	RD 8238	Adjusting Washer	RD 8323	Bearing Housing
RD 3958	Side Cover Screw (D)	RD 8243	Gear Cover Seal	RD 8324	Pinion Gear
RD 4777	Multi-Purpose Screw	RD 8254	Handle Knob Adjust Washer	RD 8325	Friction Ring
RD 5808	Bail Arm Washer	RD 8258	Worm Bushing	RD 8326	Gear Cover
RD 5812	Bail Arm Screw Collar	RD 8262	Worm Shaft Ring	RD 8327	Idle Gear (B) Collar
RD 5820	Spacer	RD 8268	Oil Cap	RD 8328	Idle Gear (B)
RD 6073	Bearing Spacer	RD 8278	Ball Bearing	RD 8329	Pinion Worm Gear
RD 6074	Line Roller Bushing	RD 8283	Drag Knob	RD 8330	Idle Gear
RD 6075	Roller Bearing Seal	RD 8284	Drag Washers Retainer	RD 8331	Worm Shaft
RD 6077	Click Pin	RD 8285	Thrust Bushing	RD 8332	Ball Bearing
RD 6156	Set Screw	RD 8286	"O" Ring	RD 8333	Drive Gear
RD 6166	Line Roller	RD 8287	Bearing Support	RD 8334	Flange Water Proof
RD 6216	"O" Ring	RD 8288	Key Washer	RD 8335	Side Cover
RD 6225	Nut Lock Screw	RD 8289	Drag Washer (A)	RD 8336	Oil Shield Cover
RD 6226	Rotor Nut Lock Plate	RD 8290	Eared Washer (A)	RD 8337	Side Cover Screw (B)
RD 6227	Bearing Washer	RD 8291	"O" Ring	RD 8338	Side Cover Screw (A)
RD 6228	Bearing Water Proof	RD 8292	Bearing Retainer	RD 8339	Handle Shaft Seal
RD 6229	Rotor Nut	RD 8293	Eared Washer (B)	RD 8340	Handle Shaft Cover (A)
RD 6236	Bail Arm Screw	RD 8294	Drag Washer (B)	RD 8341	Disc Spring
RD 6266	Oscillating Pawl Cover	RD 8295	Spool Drag Disc (A)	RD 8342	Small Handle Shank Washer
RD 6267	Oscillating Slider Bushing	RD 8296	Spool Drag Disc (B)	RD 8343	Handle Shaft Cover (B)
RD 6268	Oscillating Pawl	RD 8297	Drag Click Holder Cover	RD 8344	Handle Shank Assembly
RD 6270	Slider Retainer Screw	RD 8298	Drag Cover	RD 8345	Handle Knob (Round type C)
RD 6296	Click Spring	RD 8299	Click Spring	RD 8346	Handle Knob I.D. Plate
RD 7810	Ball Bearing	RD 8300	"O" Ring	RD 8347	Oscillating Slider
RD 7915	Ball Bearing	RD 8301	Drag Click Holder	RD 8348	Oscillating Guide
RD 8035	Ball Bearing	RD 8302	Spool Assembly	RD 8349	Worm Shaft Retainer Washer
RD 8056	Multi-Purpose Screw	RD 8303	Bearing Bushing	RD 8350	Worm Shaft Retainer
RD 8132	Bail Trip Cover Spring	RD 8304	Spool Support (A)	RD 8351	Rear Shield
RD 8144	Bearing Retainer Screw	RD 8305	Spool Support (B)	RD 8352	Rear Protector
RD 8161	Oil Cap	RD 8306	Ball Bearing	RD 8353	Body
RD 8169	Handle Knob Adjust Washer	RD 8307	Main Shaft	RD 8354	Handle Screw Cap
RD 8172	Handle Knob Nut	RD 8308	Line Roller Support Collar	RD10735	Stopper
RD 8174	Handle Knob Screw	RD 8309	Bearing Retainer Ring	RD11505	Roller Clutch Assembly
RD 8202	Ball Bearing	RD 8310	Line Roller Washer		
RD 8208	Spool Washer	RD 8311	Bail Spring	RD 8282	Handle Knob Assembly (T type B)
RD 8210	Spool Support (C)	RD 8312	Bail Spring Seat	RD 8355	Handle Assembly (T type B 10000)
RD 8211	Bearing Water Proof	RD 8313	Trip Lever Guide	RD 8356	Handle Assembly (Round type C 20000)
RD 8216	Adjusting Washer	RD 8314	Bail Trip Lever		
RD 8218	Bail Spring Guide (A)	RD 8315	Bail Trip Cover		
RD 8219	Spring Guide (A) Support	RD 8316	Bail Arm	RD 8357	Spare Handle Knob (T type B)
RD 8226	Line Roller Screw	RD 8317	Bail Spring Cover	RD 8358	Spare Handle Knob I.D. Plate
				RD 8359	Line Band (LLL)