

# SGT

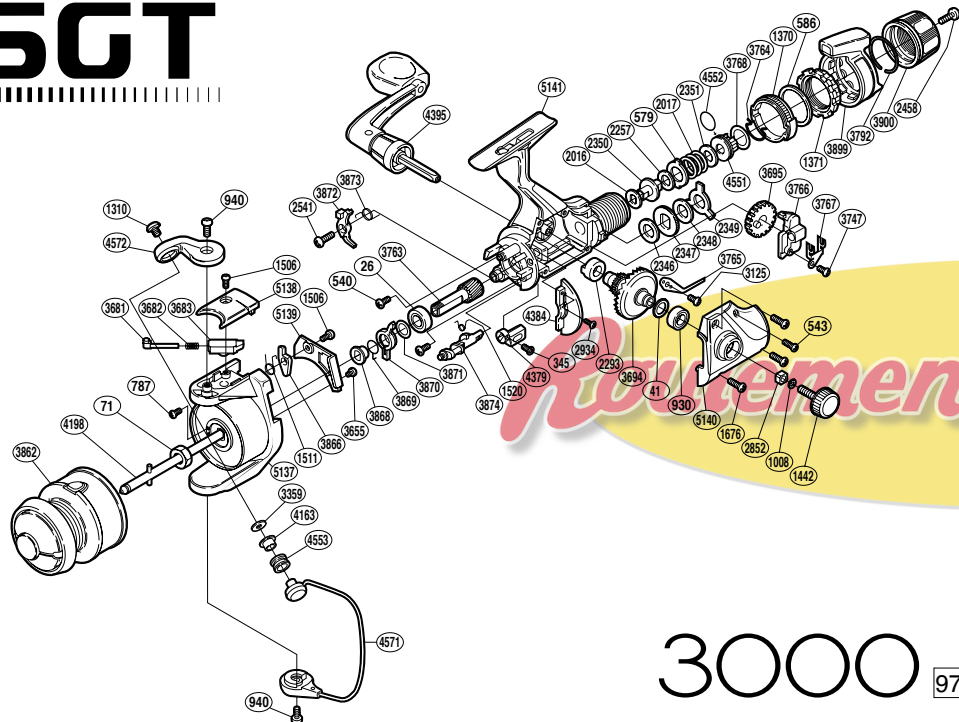

## 3000

97

RD No.	PARTS NAMES	RD No.	PARTS NAMES	RD No.	PARTS NAMES
0026	Ball Bearing	2348	Drag Washer "C" (blue)	3868	Lock Out Spring Holder
0041	Drive Gear Washer	2349	Eared Washer "Br"	3869	Anti-Reverse Lock Out Spring
0071	Rotor Nut	2350	Drag Shaft	3870	Anti-Reverse Lock Out
0345	Anti-Reverse Lever Screw	2351	Drag Spring Washer	3871	Bushing Washer
0540	Bearing Retainer Screw	2458	Drag Programmer Screw	3872	Anti-Reverse Pawl
0543	Side Cover Screw (small)	2541	Anti-Reverse Pawl Screw	3873	Anti-Reverse Pawl Spring
0579	Eared Washer "B"	2852	Handle Screw Lock	3874	Anti-Reverse Cam
0586	Fightin' Pressure Screw Washer	2934	Flange Screw	3899	Fightin' Drag Lever
0787	Nut Lock Screw	3125	Drag Click Screw	3900	Drag Programmer
0930	Ball Bearing	3359	Line Roller Washer	4163	Line Roller Bushing
0940	Multi-Purpose Screw	3655	Cover Screw	4198	Main Shaft
1008	Handle Lock Washer	3681	Bail Spring Guide (A)	4379	Anti-Reverse Lever
1310	Line Roller Screw	3682	Bail Spring	4384	Side Cover Flange
1370	Lever Click Gear	3683	Bail Spring Guide (B)	4395	Handle Assembly
1371	Fightin' Pressure Screw	3694	Drive Gear	4551	Pressure Screw
1442	Handle Screw Cap	3695	Oscillating Gear	4552	"O" Ring
1506	Multi-Purpose Screw	3747	Slider Retainer Screw	4553	Line Roller
1511	Lever Spring	3763	Pinion Gear	4571	Bail Assembly
1520	Anti-Reverse Cam Spring	3764	Hold Click Spring	4572	Bail Arm
1676	Side Cover Screw (large)	3765	Drag Click	5137	Rotor
2016	Drag Washer "H" (cloth)	3766	Oscillating Slider	5138	Bail Spring Cover
2017	Drag Coil Spring	3767	Oscillating Slider Retainer	5139	Counterbalance Cover
2257	Drag Washer "H" (blue)	3768	Drag Programmer Spacer	5140	Side Cover
2293	Drive Gear Bushing	3792	Lever Hold Spring	5141	Body
2346	Drag Washer "C" (cloth)	3862	Spool Assembly (S-3)		
2347	Click Gear	3866	Bail Trip Lever		

(080713)