

DX

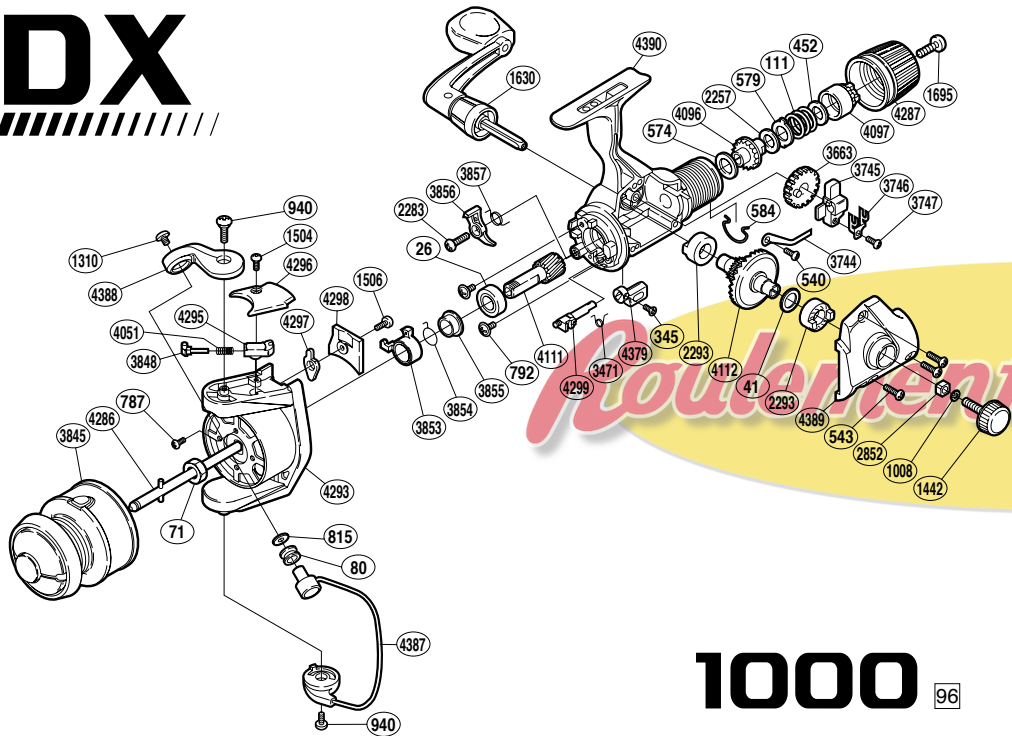

1000

96

| RD No. | PARTS NAMES | RD No. | PARTS NAMES | RD No. | PARTS NAMES |
|--------|--------------------------|--------|------------------------------|--------|-----------------------|
| 0026 | Ball Bearing | 1506 | Bail Trip Lever Screw | 4051 | Bail Spring |
| 0041 | Drive Gear Washer | 1630 | Handle Assembly | 4096 | Drag Shaft |
| 0071 | Rotor Nut | 1695 | Drag Knob Screw | 4097 | Pressure Screw |
| 0080 | Line Roller | 2257 | Drag Washer "H"(blue) | 4111 | Pinion Gear |
| 0111 | Drag Coil Spring | 2283 | Anti-Reverse Pawl Screw | 4112 | Drive Gear |
| 0345 | Anti-Reverse Lever Screw | 2293 | Drive Gear Bushing | 4286 | Main Shaft Assembly |
| 0452 | Drag Spring Washer | 2852 | Handle Screw Lock | 4287 | Drag Knob Assembly |
| 0540 | Drag Click Screw | 3471 | Anti-Reverse Cam Spring | 4293 | Rotor |
| 0543 | Side Cover Screw | 3663 | Oscillating Gear | 4295 | Bail Spring Guide (B) |
| 0574 | Drag Washer "C"(cloth) | 3744 | Drag Click | 4296 | Bail Spring Cover |
| 0579 | Eared Washer "B" | 3745 | Oscillating Slider | 4297 | Bail Trip Lever |
| 0584 | Hold Click Spring | 3746 | Oscillating Slider Retainer | 4298 | Counterbalance Cover |
| 0787 | Nut Lock Screw | 3747 | Slider Retainer Screw | 4299 | Anti-Reverse Cam |
| 0792 | Bearing Retainer Screw | 3845 | Spool Assembly (S-1) | 4379 | Anti-Reverse Lever |
| 0815 | Line Roller Washer | 3848 | Bail Spring Guide (A) | 4387 | Bail Assembly |
| 0940 | Multi-Purpose Screw | 3853 | Anti-Reverse Lock Out | 4388 | Bail Arm |
| 1008 | Handle Lock Washer | 3854 | Anti-Reverse Lock Out Spring | 4389 | Side Cover |
| 1310 | Line Roller Screw | 3855 | Lock Out Spring Holder | 4390 | Body |
| 1442 | Handle Screw Cap | 3856 | Anti-Reverse Pawl | | |
| 1504 | Bail Spring Cover Screw | 3857 | Anti-Reverse Pawl Spring | | |

(070602)