

SHIMANO

SIENNA

SN2500RE

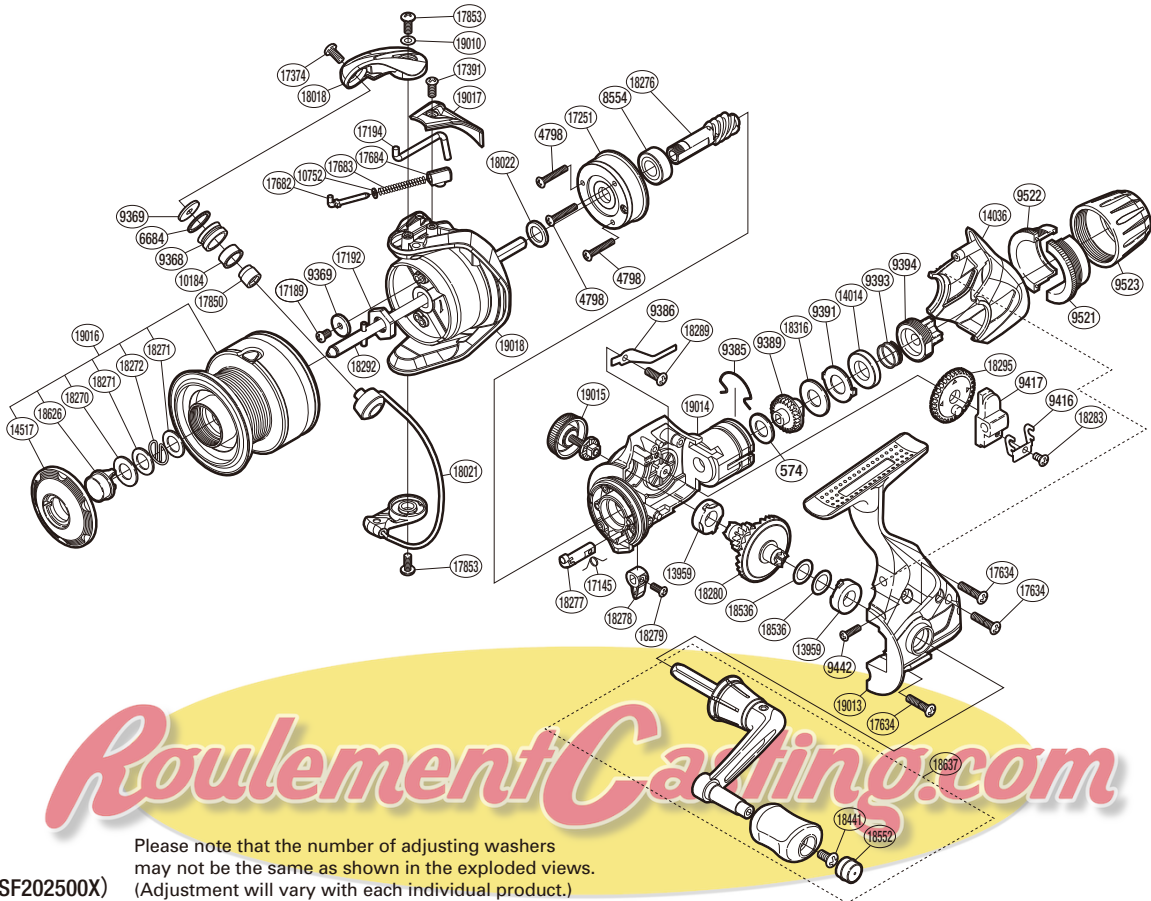

| Part No. | Description | Part No. | Description | Part No. | Description |
|----------|-----------------------------|----------|-------------------------|----------|--------------------|
| RD 0574 | Drag Washer | RD14036 | Rear Protector | RD18277 | Anti-Reverse Cam |
| RD 4798 | Screw | RD14517 | Push Button Collar | RD18278 | Anti-Reverse Lever |
| RD 6684 | Line Roller Spacer | RD17145 | Anti-Reverse Cam Spring | RD18279 | Screw |
| RD 8554 | Ball Bearing | RD17189 | Screw | RD18280 | Drive Gear |
| RD 9368 | Line Roller | RD17192 | Rotor Nut | RD18283 | Screw |
| RD 9369 | Washer | RD17194 | Bail Trip Lever | RD18289 | Screw |
| RD 9385 | Hold Click Spring | RD17251 | Roller Clutch Assembly | RD18292 | Main Shaft |
| RD 9386 | Drag Click | RD17374 | Screw | RD18295 | Oscillating Gear |
| RD 9389 | Drag Shaft | RD17391 | Screw | RD18316 | Drag Washer |
| RD 9391 | Eared Washer | RD17634 | Screw | RD18441 | Screw |
| RD 9393 | Drag Coil Spring | RD17682 | Bail Spring Guide A | RD18536 | Washer |
| RD 9394 | Pressure Screw | RD17683 | Bail Spring | RD18552 | Handle Knob Seal |
| RD 9416 | Oscillating Slider Retainer | RD17684 | Bail Spring Seat | RD18626 | Push Button |
| RD 9417 | Oscillating Slider | RD17850 | Line Roller Collar | RD18637 | Handle Assembly |
| RD 9442 | Screw | RD17853 | Screw | RD19010 | Washer |
| RD 9521 | Drag Programmer B1 | RD18018 | Bail Arm | RD19013 | Side Cover |
| RD 9522 | Drag Programmer B2 | RD18021 | Bail Assembly | RD19014 | Body |
| RD 9523 | Drag Programmer A | RD18022 | Washer | RD19015 | Handle Screw Cap |
| RD10184 | Line Roller Bushing | RD18270 | Washer | RD19016 | Spool Assembly |
| RD10752 | Bail Spring Guide A Support | RD18271 | Washer | RD19017 | Bail Spring Cover |
| RD13959 | Drive Gear Bushing | RD18272 | Locking Spring | RD19018 | Rotor |
| RD14014 | Drag Collar | RD18276 | Pinion Gear | | |