

SHIMANO

CALCUTTA CONQUEST

SA-RB

CTCQ-301

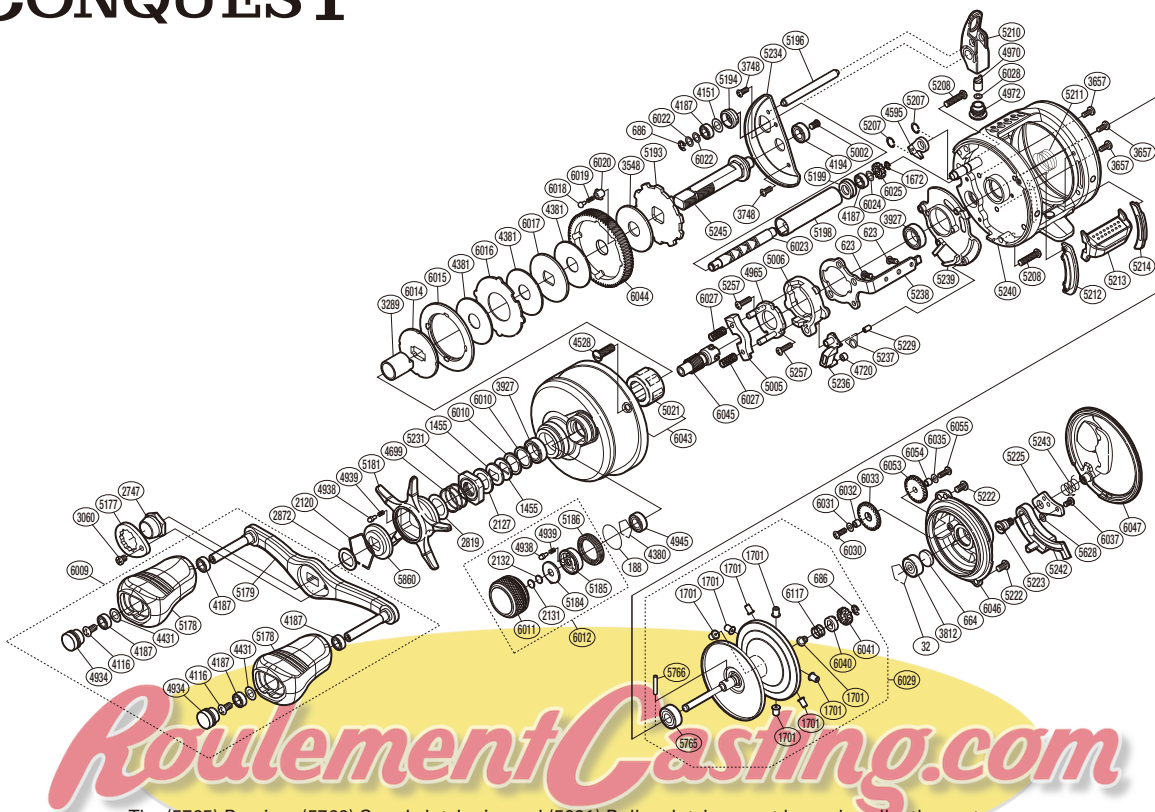

The (5765) Bearing, (5766) Spool clutch pin, and (5021) Roller clutch cannot be replaced by the customer.
To replace these parts, please request after-sales service.

Please note that the number of adjusting washers may not be the same as shown in the exploded views.
(Adjustment will vary with each individual product.)

(51RL090301X)

Part No.	Description	Part No.	Description	Part No.	Description
BNT0032	Bearing Retainer	BNT5002	Screw	BNT5766	Spool Clutch Pin
BNT0188	O Ring	BNT5005	Yoke	BNT5860	Star Drag Click Plate
BNT0623	Screw	BNT5006	Clutch Cam	BNT6009	Handle Assembly
BNT0664	Spacer B	BNT5021	Roller Clutch Bearing	BNT6010	Washer
BNT0686	E Lock	BNT5177	Handle Nut Plate	BNT6011	Cast Control Cap
BNT1455	Drag Spring Washer (H)	BNT5178	Handle Knob	BNT6012	Cast Control Cap Assembly
BNT1672	E Lock	BNT5179	Handle Shank Assembly	BNT6014	Pressure Plate
BNT1701	Brake Collar (Gray)	BNT5181	Star Drag	BNT6015	Drag Click Ratchet
BNT2120	Click Plate Retainer	BNT5184	Cast Control Click Plate	BNT6016	Eared Washer
BNT2127	Star Drag Spacer	BNT5185	Click Pin Holder	BNT6017	Drag Washer
BNT2131	Spool Tension Spacer B	BNT5186	Cast Control Click Holder	BNT6018	Drag Click
BNT2132	Spool Tension Spacer A	BNT5193	Anti-Reverse Ratchet	BNT6019	Click Spring
BNT2747	Handle Nut	BNT5194	Worm Bushing A	BNT6020	Drag Click Pin Holder
BNT2819	Washer	BNT5196	Level Wind Guide	BNT6022	Washer
BNT2872	Friction Washer	BNT5198	Level Wind Guard	BNT6023	Worm Shaft
BNT3060	Screw	BNT5199	Worm Bushing B	BNT6024	Washer
BNT3289	Roller Clutch Inner Tube	BNT5207	C Lock	BNT6025	Idle Gear C
BNT3548	Drag Washer	BNT5208	Screw	BNT6027	Yoke Spring
BNT3657	Screw	BNT5210	Line Guide Assembly	BNT6028	Washer
BNT3748	Screw	BNT5211	Bearing Pressure Spring	BNT6029	Spool Assembly(With Bearing)
BNT3812	Ball Bearing	BNT5212	Clutch Bar Guide B	BNT6030	Screw
BNT3927	Ball Bearing	BNT5213	Quick-Fire li Clutch Bar	BNT6031	Washer
BNT4116	Screw	BNT5214	Clutch Bar Guide A	BNT6032	Idle Gear B Support
BNT4151	Washer	BNT5222	Screw	BNT6033	Idle Gear B
BNT4187	Ball Bearing	BNT5223	B Side Plate Insert	BNT6035	Washer
BNT4194	Ball Bearing	BNT5225	Damper Bush	BNT6037	Screw
BNT4380	Retainer	BNT5229	Clutch Pawl Spring Collar	BNT6040	Spool Shaft Cam
BNT4381	Drag Washer	BNT5231	Star Drag Nut	BNT6041	Idle Gear A
BNT4431	Washer	BNT5234	Drive Shaft Retainer	BNT6043	Left Side Plate Assembly
BNT4528	Screw	BNT5236	Clutch Pawl	BNT6044	Drive Gear
BNT4595	Anti-Reverse Pawl Assembly	BNT5237	Clutch Pawl Spring	BNT6045	Pinion Gear
BNT4699	Star Drag Spring	BNT5238	Clutch Plate	BNT6046	Brake Case Assembly
BNT4720	Clutch Pawl Bushing	BNT5239	Clutch Guard	BNT6047	Right Side Plate Assembly
BNT4934	Handle Knob Seal	BNT5240	Frame Assembly	BNT6053	Idle Gear D
BNT4938	Click Pin	BNT5242	Side Plate Cam Lever	BNT6054	Idle Gear D Support
BNT4939	Click Spring	BNT5243	Damper Spring	BNT6055	Screw
BNT4945	Ball Bearing	BNT5245	Drive Shaft	BNT6117	Spool Shaft Spring
BNT4965	Clutch Cam Retainer	BNT5257	Screw		
BNT4970	Line Guide Pawl	BNT5628	Washer		
BNT4972	Pawl Cap	BNT5765	Ball Bearing	BNT6042	Brake Collar (Clear) (accessory)