

SHIMANO

ALDEBARAN  A-RB
MCL

ALD MGL-51

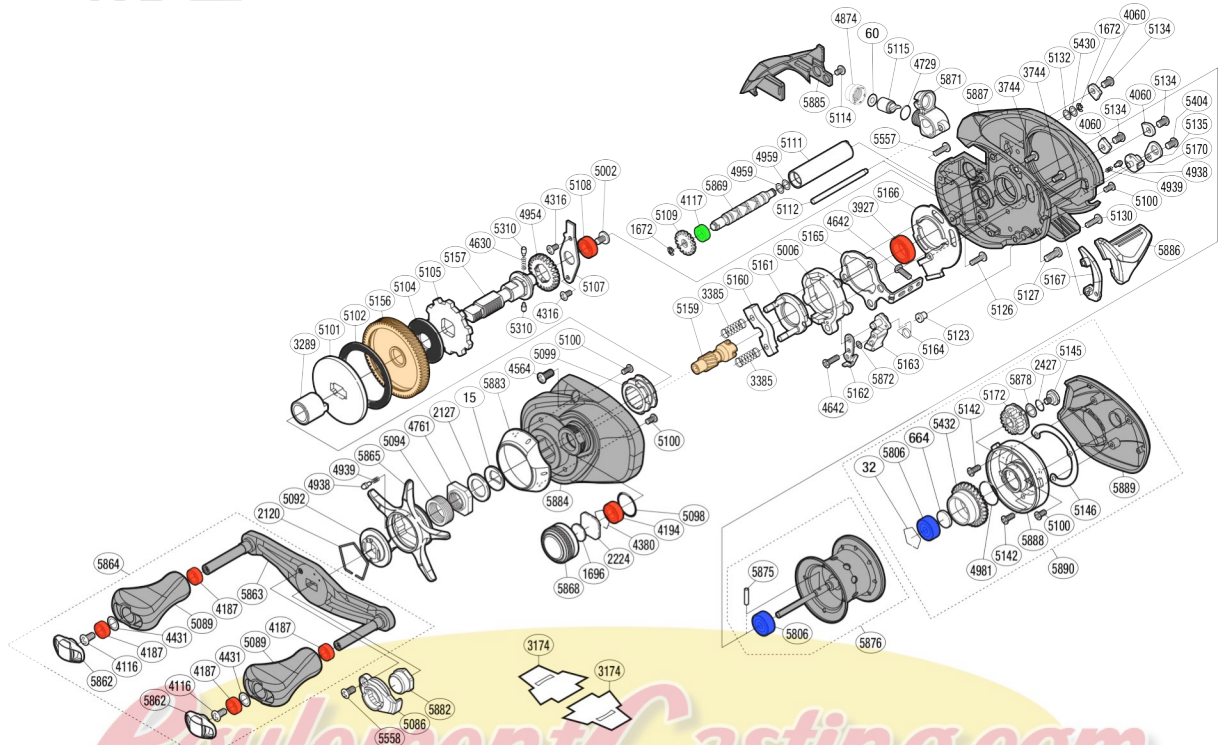

The (5806) Bearing, (5875) Spool clutch pin, and (5099) Roller clutch cannot be replaced by the customer. To replace these parts, please request after-sales service.

Please note that the number of adjusting washers may not be the same as shown in the exploded views. (Adjustment will vary with each individual product.)

(51RL120051X)

HowlementCasting.com