

# SHIMANO

## ULTEGRA S A-RB

## ULT-C3000FB

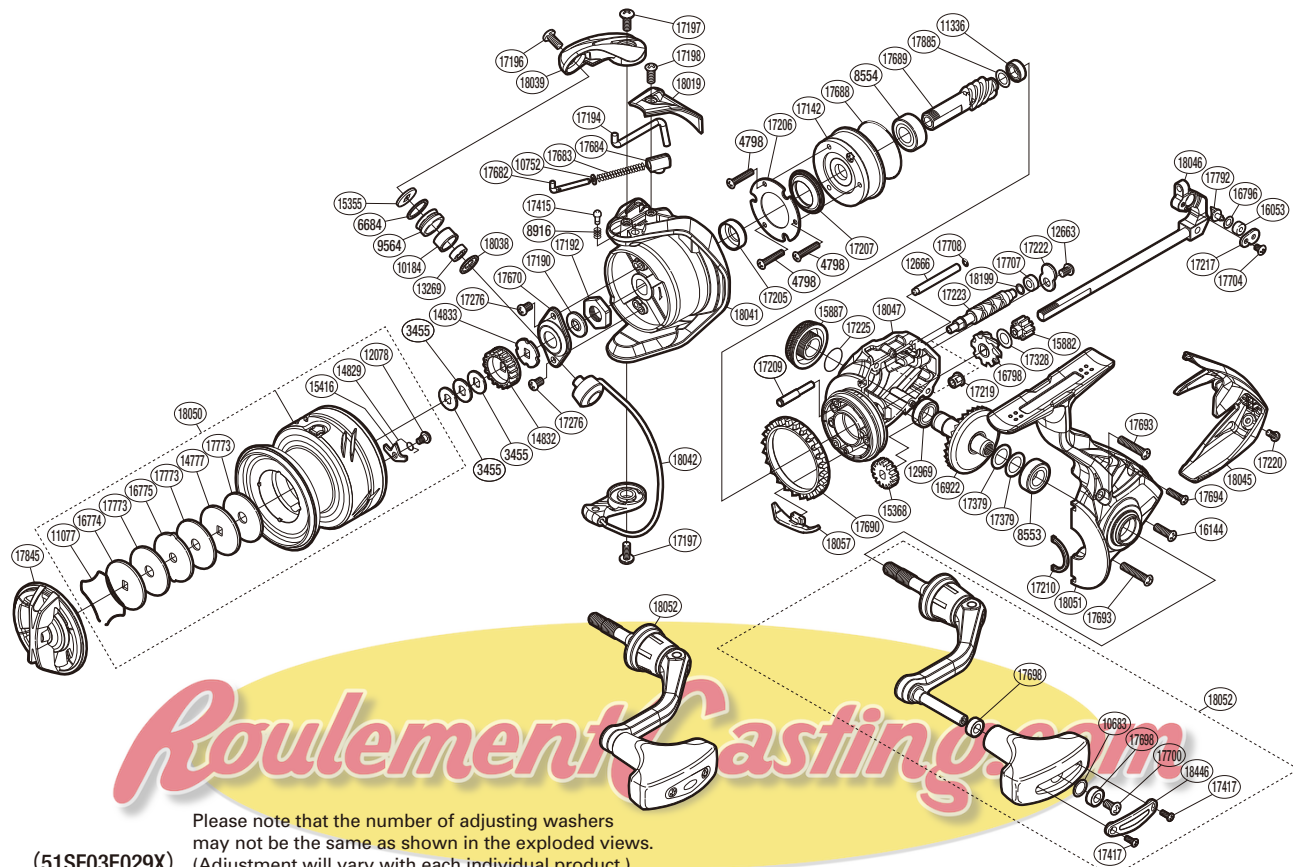

Please note that the number of adjusting washers may not be the same as shown in the exploded views.

(51SF03E029X) (Adjustment will vary with each individual product.)

| Part No. | Description                    | Part No. | Description               | Part No. | Description             |
|----------|--------------------------------|----------|---------------------------|----------|-------------------------|
| RD 3455  | Spool Washer                   | RD16922  | Drive Gear **             | RD17694  | Screw                   |
| RD 4798  | Screw                          | RD17142  | Roller Clutch Assembly    | RD17698  | Handle Knob Bushing     |
| RD 6684  | Line Roller Spacer *           | RD17190  | Bearing Water Proof       | RD17700  | Screw                   |
| RD 8553  | Ball Bearing ****              | RD17192  | Rotor Nut                 | RD17704  | Screw                   |
| RD 8554  | Ball Bearing ****              | RD17194  | Bail Trip Lever           | RD17707  | Worm Bushing ***        |
| RD 8916  | Click Spring                   | RD17196  | Screw *                   | RD17708  | O Ring                  |
| RD 9564  | Line Roller *                  | RD17197  | Screw                     | RD17773  | Drag Washer             |
| RD10184  | Line Roller Bushing *          | RD17198  | Screw                     | RD17792  | Oscillating Pawl ***    |
| RD10683  | Washer                         | RD17205  | Rotor Ring                | RD17845  | Drag Knob               |
| RD10752  | Bail Spring Guide A Support    | RD17206  | Roller Clutch Reinforce   | RD17885  | Washer ****             |
| RD11077  | Drag Washers Retainer          | RD17207  | Roller Clutch Water Proof | RD18019  | Bail Spring Cover       |
| RD11336  | Ball Bearing ****              | RD17209  | Idle Gear B Shaft         | RD18038  | Line Roller Support B * |
| RD12078  | Screw                          | RD17210  | Flange Water Proof        | RD18039  | Bail Arm                |
| RD12663  | Screw                          | RD17217  | Oscillating Pawl Cover    | RD18041  | Rotor                   |
| RD12666  | Oscillating Guide A            | RD17219  | Worm Bushing (Front) ***  | RD18042  | Bail Assembly           |
| RD12969  | Ball Bearing ****              | RD17220  | Screw                     | RD18045  | Rear Protector          |
| RD13269  | Ball Bearing *                 | RD17222  | Worm Shaft Retainer       | RD18046  | Main Shaft Assembly     |
| RD14777  | Key Washer                     | RD17223  | Worm Shaft ***            | RD18047  | Body                    |
| RD14829  | Drag Click Spring              | RD17225  | O Ring                    | RD18050  | Spool Assembly          |
| RD14832  | Spool Support A                | RD17276  | Screw                     | RD18051  | Side Cover              |
| RD14833  | Spool Support B                | RD17328  | Washer **                 | RD18052  | Handle Assembly         |
| RD15355  | Line Roller Washer *           | RD17379  | Washer **/****            | RD18057  | Bail Trip Strike        |
| RD15368  | Idle Gear **                   | RD17415  | Click Pin                 | RD18199  | Washer ***              |
| RD15416  | Drag Click                     | RD17417  | Screw                     | RD18446  | Handle Knob I.D. Plate  |
| RD15882  | Idle Gear B (Small) **         | RD17670  | Rotor Nut Lock Plate      |          |                         |
| RD15887  | Handle Screw Cap               | RD17682  | Bail Spring Guide A       | RD18054  | Anti Line Slip Sticker  |
| RD16053  | Oscillating Slider Bushing *** | RD17683  | Bail Spring               |          |                         |
| RD16144  | Screw                          | RD17684  | Bail Spring Seat          |          |                         |
| RD16774  | Key Washer                     | RD17688  | O Ring                    | PK 0432  | Line Roller Set *       |
| RD16775  | Eared Washer                   | RD17689  | Pinion Gear **            | PK 0361  | Gear Set **             |
| RD16796  | Spacer ***                     | RD17690  | Friction Ring             | PK 0416  | Oscillation Set ***     |
| RD16798  | Idle Gear B (Large) **         | RD17693  | Screw                     | PK 0433  | Bearing Set ****        |