

# SHIMANO

CAIUS S A-RB

CIS-151A

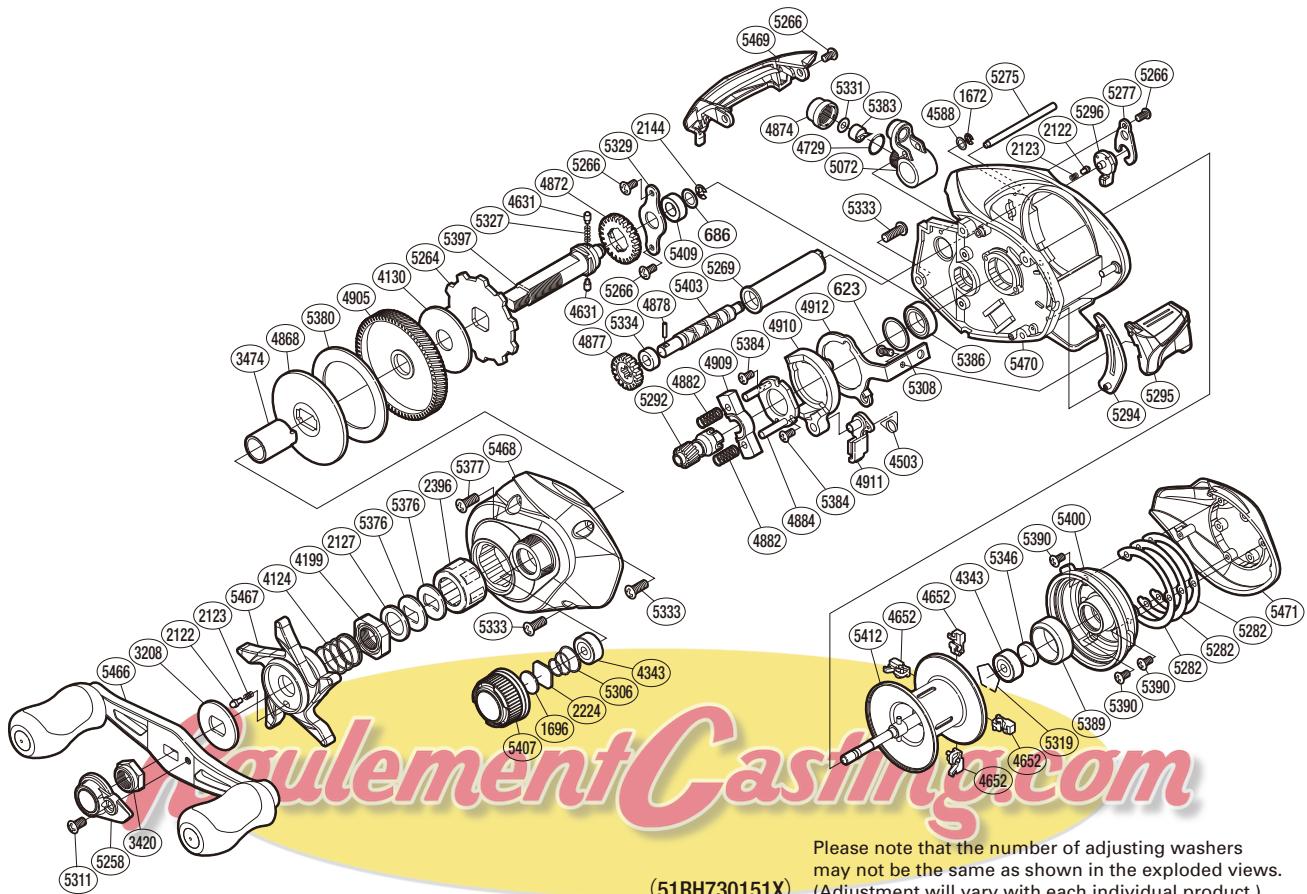

Please note that the number of adjusting washers may not be the same as shown in the exploded views. (Adjustment will vary with each individual product.)

(51RH730151X)

| Part No. | Description              | Part No. | Description          | Part No. | Description           |
|----------|--------------------------|----------|----------------------|----------|-----------------------|
| BNT0623  | Screw                    | BNT4878  | Worm Shaft Pin       | BNT5331  | Spacer                |
| BNT0686  | E Lock                   | BNT4882  | Yoke Spring          | BNT5333  | Screw                 |
| BNT1672  | E Lock                   | BNT4884  | Clutch Cam Retainer  | BNT5334  | Bushing               |
| BNT1696  | Cast Control Spacer (B)  | BNT4905  | Drive Gear           | BNT5346  | Spacer B              |
| BNT2122  | Click Pin                | BNT4909  | Yoke                 | BNT5376  | Drag Spring Washer    |
| BNT2123  | Click Spring             | BNT4910  | Clutch Cam           | BNT5377  | Screw                 |
| BNT2127  | Star Drag Spacer         | BNT4911  | Clutch Pawl          | BNT5380  | Drag Washer           |
| BNT2144  | Drive Shaft Washer       | BNT4912  | Clutch Plate         | BNT5383  | Line Guide Pawl       |
| BNT2224  | Spool Tension Spacer (A) | BNT5072  | Line Guide           | BNT5384  | Screw                 |
| BNT2396  | Roller Clutch Bearing    | BNT5258  | Handle Nut Plate     | BNT5386  | Ball Bearing          |
| BNT3208  | Star Drag Click Plate    | BNT5264  | Anti-reverse Ratchet | BNT5389  | Brake Ring            |
| BNT3420  | Handle Nut               | BNT5266  | Screw                | BNT5390  | Screw                 |
| BNT3474  | Roller Clutch Inner Tube | BNT5269  | Level Wind Guard     | BNT5397  | Drive Shaft           |
| BNT4124  | Star Drag Spring         | BNT5275  | Stabilizer Bar       | BNT5400  | Dial Case             |
| BNT4130  | Drag Washer              | BNT5277  | Cam Lever Retainer   | BNT5403  | Worm Shaft            |
| BNT4199  | Star Drag Nut            | BNT5282  | Washer               | BNT5407  | Cast Control Cap      |
| BNT4343  | Ball Bearing             | BNT5292  | Pinion Gear          | BNT5409  | Drive Shaft Bushing   |
| BNT4503  | Clutch Pawl Spring       | BNT5294  | Clutch Bar Guide     | BNT5412  | Spool Assembly        |
| BNT4588  | Washer                   | BNT5295  | Clutch Lever         | BNT5466  | Handle Assembly       |
| BNT4631  | Idle Gear Pin            | BNT5296  | Side Plate Cam Lever | BNT5467  | Star Drag             |
| BNT4652  | Brake Shoe M             | BNT5306  | Spool Tension Spring | BNT5468  | Left Side Plate       |
| BNT4729  | O Ring                   | BNT5308  | Washer               | BNT5469  | Level Wind Protector  |
| BNT4868  | Key Washer               | BNT5311  | Screw                | BNT5470  | Frame                 |
| BNT4872  | Idle Gear                | BNT5319  | Bearing Retainer     | BNT5471  | Right Side Plate      |
| BNT4874  | Pawl Cap                 | BNT5327  | Idle Gear Spring     |          |                       |
| BNT4877  | Idle Gear                | BNT5329  | Drive Shaft Retainer | BNT4692  | B-100 Oil (accessory) |