

SHIMANO

CURADO S A-RB

CU-200IHG

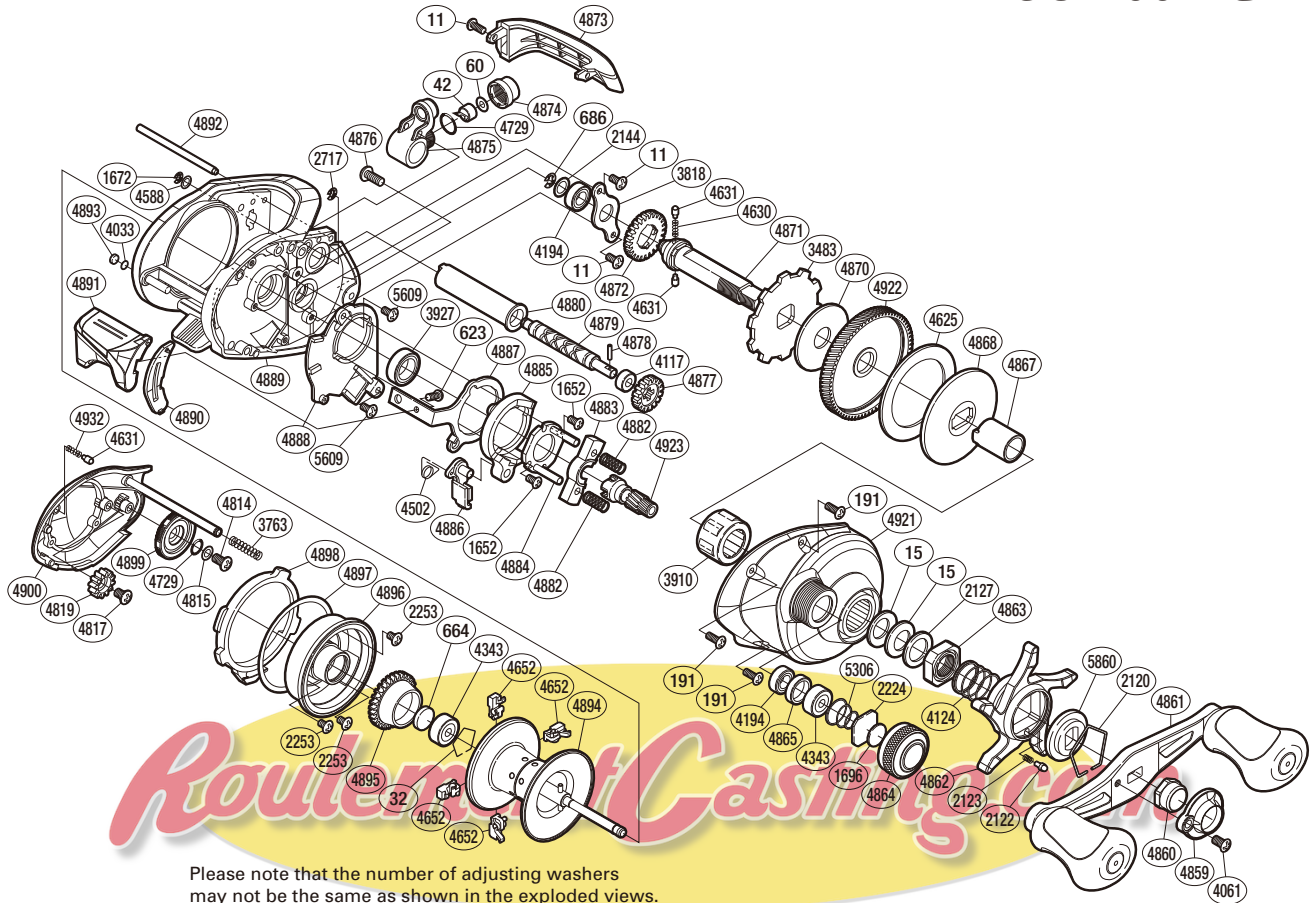

Please note that the number of adjusting washers may not be the same as shown in the exploded views. (Adjustment will vary with each individual product.)

(51RH39G200U)

| Part No. | Description | Part No. | Description | Part No. | Description |
|----------|-----------------------|----------|--------------------------|----------|--------------------------|
| BNT0011 | Screw | BNT4343 | Ball Bearing | BNT4879 | Worm Shaft |
| BNT0015 | Drag Spring Washer | BNT4502 | Clutch Pawl Spring | BNT4880 | Level Wind Guard |
| BNT0032 | Bearing Retainer | BNT4588 | Washer | BNT4882 | Yoke Spring |
| BNT0042 | Line Guide Pawl | BNT4625 | Drag Washer | BNT4883 | Yoke |
| BNT0060 | Spacer | BNT4630 | Idle Gear Spring | BNT4884 | Clutch Cam Retainer |
| BNT0191 | Screw | BNT4631 | Idle Gear Pin | BNT4885 | Clutch Cam |
| BNT0623 | Screw | BNT4652 | Brake Shoe | BNT4886 | Clutch Pawl |
| BNT0664 | Spacer B | BNT4729 | O Ring | BNT4887 | Clutch Plate |
| BNT0686 | E Lock | BNT4814 | Screw | BNT4888 | Clutch Guard |
| BNT1652 | Screw | BNT4815 | Washer | BNT4889 | One-Piece Frame |
| BNT1672 | E Lock | BNT4817 | Screw | BNT4890 | Clutch Bar Guide |
| BNT1696 | Cast Control Spacer | BNT4819 | Idle Gear | BNT4891 | Quick-Fire II Clutch Bar |
| BNT2120 | Click Plate Retainer | BNT4859 | Handle Nut Plate | BNT4892 | Stabilizer Bar |
| BNT2122 | Click Pin | BNT4860 | Handle Nut | BNT4893 | Anti-Thrust Washer |
| BNT2123 | Click Spring | BNT4861 | Handle Assembly | BNT4894 | Spool Assembly |
| BNT2127 | Star Drag Spacer | BNT4862 | Star Drag | BNT4895 | Brake Ring Gear |
| BNT2144 | Washer | BNT4863 | Star Drag Nut | BNT4896 | Brake Case |
| BNT2224 | Spool Tension Spacer | BNT4864 | Cast Control Cap | BNT4897 | Washer |
| BNT2253 | Screw | BNT4865 | Bearing Spacer | BNT4898 | Side Plate Cam Lever |
| BNT2717 | E Lock | BNT4867 | Roller Clutch Inner Tube | BNT4899 | Brake Dial |
| BNT3483 | Anti-Reverse Ratchet | BNT4868 | Key Washer | BNT4900 | Left Side Plate |
| BNT3763 | Side Plate Spring | BNT4870 | Drag Washer | BNT4921 | Right Side Plate |
| BNT3818 | Drive Shaft Retainer | BNT4871 | Drive Shaft | BNT4922 | Drive Gear |
| BNT3910 | Roller Clutch Bearing | BNT4872 | Idle Gear | BNT4923 | Pinion Gear |
| BNT3927 | Ball Bearing | BNT4873 | Level Wind Protector | BNT4932 | Click Spring |
| BNT4033 | Washer | BNT4874 | Pawl Cap | BNT5306 | Spool Tension Spring |
| BNT4061 | Screw | BNT4875 | Line Guide | BNT5609 | Screw |
| BNT4117 | Bushing | BNT4876 | Screw | BNT5860 | Star Drag Click Plate |
| BNT4124 | Star Drag Spring | BNT4877 | Idle Gear | | |
| BNT4194 | Ball Bearing | BNT4878 | Worm Shaft Pin | BNT4692 | B-100 Oil (accessory) |