

# SHIMANO

## CRUXIS

## CRX-200

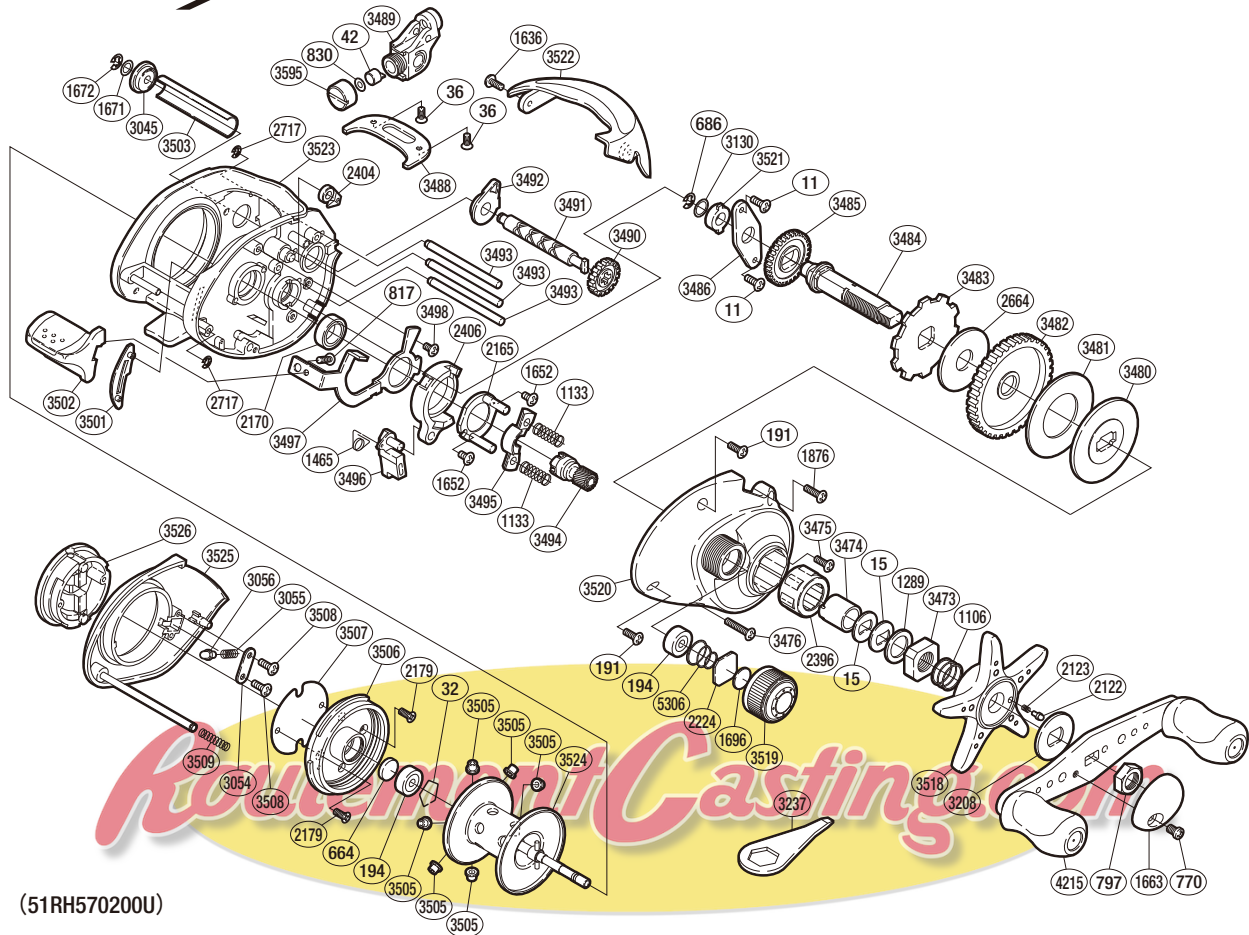

(51RH570200U)

Part No.	Description	Part No.	Description	Part No.	Description
BNT0011	Screw	BNT2224	Spool Tension Spacer	BNT3494	Pinion Gear
BNT0015	Drag Spring Washer	BNT2396	Roller Clutch Bearing	BNT3495	Yoke
BNT0032	Bearing Retainer	BNT2404	Anti-Reverse Pawl	BNT3496	Clutch Pawl
BNT0036	Screw	BNT2406	Clutch Cam	BNT3497	Clutch Plate
BNT0042	Line Guide Pawl	BNT2664	Drag Washer	BNT3498	Screw
BNT0191	Screw	BNT2717	E Lock	BNT3501	Clutch Bar Guide
BNT0194	Ball Bearing	BNT3045	Worm Bushing B	BNT3502	Quick-Fire II Clutch Bar
BNT0664	Spacer B	BNT3054	Click Pin Retainer	BNT3503	Level Wind Guard
BNT0686	E Lock	BNT3055	Click Spring	BNT3505	Brake Collar (Red)
BNT0770	Screw	BNT3056	Click Pin	BNT3506	Brake Case
BNT0797	Handle Nut	BNT3130	Washer	BNT3507	Brake Case Spacer
BNT0817	Screw	BNT3208	Star Drag Click Plate	BNT3508	Screw
BNT0830	Spacer	BNT3473	Star Drag Nut	BNT3509	Side Plate Spring
BNT1106	Star Drag Spring	BNT3474	Roller Clutch Inner Tube	BNT3518	Star Drag
BNT1133	Yoke Spring	BNT3475	Screw	BNT3519	Cast Control Cap
BNT1289	Star Drag Spacer	BNT3476	Screw	BNT3520	Right Side Plate
BNT1465	Clutch Pawl Spring	BNT3480	Key Washer	BNT3521	Drive Shaft Bushing
BNT1636	Screw	BNT3481	Drag Washer	BNT3522	Thumb Rest
BNT1652	Screw	BNT3482	Drive Gear	BNT3523	One-Piece Frame
BNT1663	Handle Nut Plate	BNT3483	Anti-Reverse Ratchet	BNT3524	Spool Assembly
BNT1671	Washer	BNT3484	Drive Shaft	BNT3525	Left Side Plate
BNT1672	E Lock	BNT3485	Idle Gear A	BNT3526	Turnkey Dial
BNT1696	Cast Control Spacer	BNT3486	Drive Shaft Retainer	BNT3595	Pawl Cap
BNT1876	Screw	BNT3488	Line Guard	BNT4215	Handle Assembly
BNT2122	Click Pin	BNT3489	Line Guide	BNT5306	Spool Tension Spring
BNT2123	Click Spring	BNT3490	Idle Gear C		
BNT2165	Clutch Cam Retainer	BNT3491	Worm Shaft		
BNT2170	Ball Bearing	BNT3492	Worm Bushing A		
BNT2179	Screw	BNT3493	Stabilizer Bar	BNT3237	Wrench (accessory)

(151023)