

SHIMANO

CITICA

CI-201D

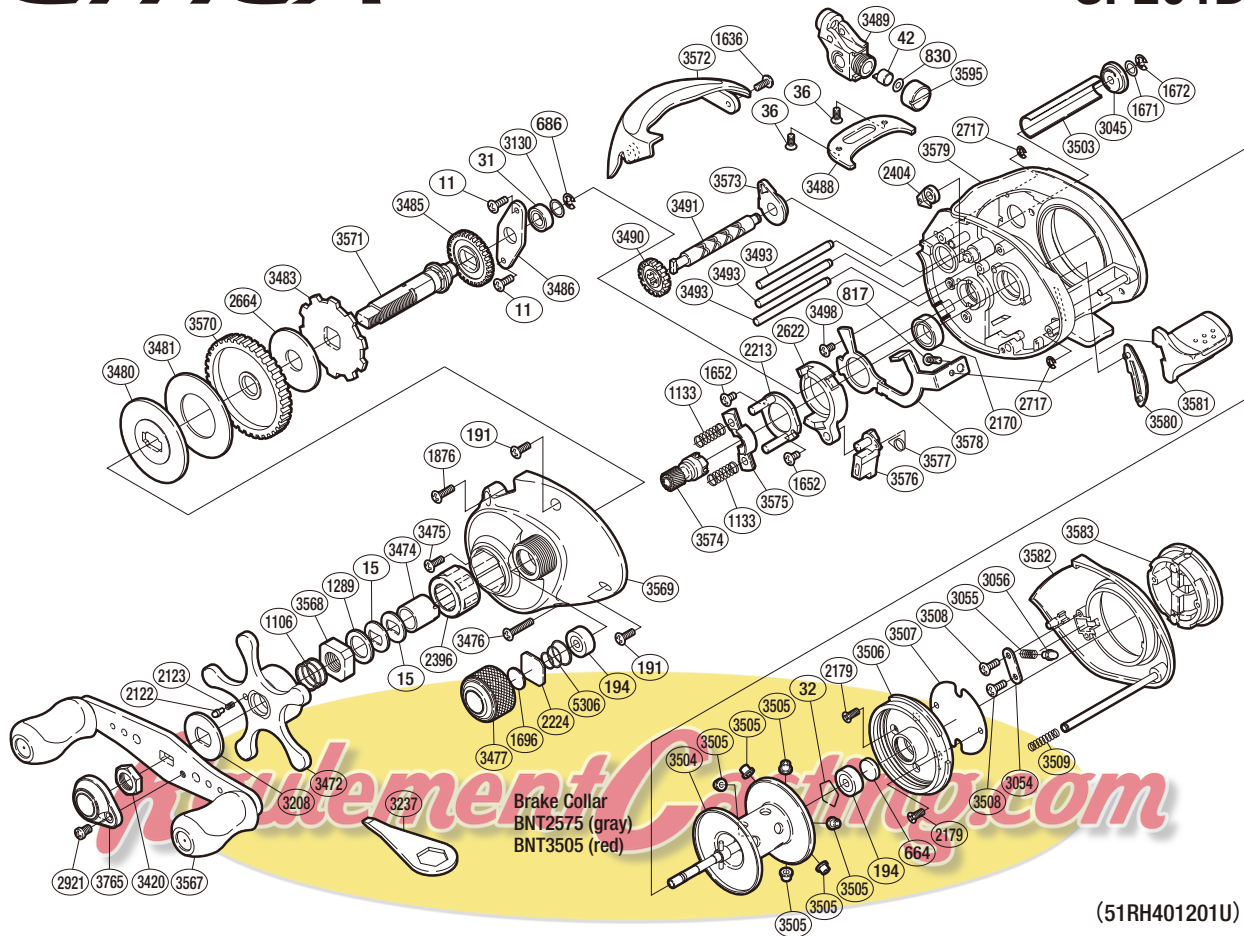

(51RH401201U)

Part No.	Description	Part No.	Description	Part No.	Description
BNT0011	Screw	BNT2622	Clutch Cam	BNT3505	Brake Collar (Red)
BNT0015	Drag Spring Washer	BNT2664	Drag Washer	BNT3506	Brake Case
BNT0031	Ball Bearing	BNT2717	E Lock	BNT3507	Brake Case Spacer
BNT0032	Bearing Retainer	BNT2921	Screw	BNT3508	Screw
BNT0036	Screw	BNT3045	Worm Bushing B	BNT3509	Side Plate Spring
BNT0042	Line Guide Pawl	BNT3054	Click Pin Retainer	BNT3567	Handle Assembly
BNT0191	Screw	BNT3055	Click Spring	BNT3568	Star Drag Nut
BNT0194	Ball Bearing	BNT3056	Click Pin	BNT3569	Left Side Plate
BNT0664	Spacer B	BNT3130	Washer	BNT3570	Drive Gear
BNT0686	E Lock	BNT3208	Star Drag Click Plate	BNT3571	Drive Shaft
BNT0817	Screw	BNT3420	Handle Nut	BNT3572	Thumb Rest
BNT0830	Spacer	BNT3472	Star Drag	BNT3573	Worm Bushing A
BNT1106	Star Drag Spring	BNT3474	Roller Clutch Inner Tube	BNT3574	Pinion Gear
BNT1133	Yoke Spring	BNT3475	Screw	BNT3575	Yoke
BNT1289	Star Drag Spacer	BNT3476	Screw	BNT3576	Clutch Pawl
BNT1636	Screw	BNT3477	Cast Control Cap	BNT3577	Clutch Pawl Spring
BNT1652	Screw	BNT3480	Key Washer	BNT3578	Clutch Plate
BNT1671	Washer	BNT3481	Drag Washer	BNT3579	One-Piece Frame
BNT1672	E Lock	BNT3483	Anti-Reverse Ratchet	BNT3580	Clutch Bar Guide
BNT1696	Cast Control Spacer	BNT3485	Idle Gear A	BNT3581	Quick-Fire II Clutch Bar
BNT1876	Screw	BNT3486	Drive Shaft Retainer	BNT3582	Right Side Plate
BNT2122	Click Pin	BNT3488	Line Guard	BNT3583	Turnkey Dial
BNT2123	Click Spring	BNT3489	Line Guide	BNT3595	Pawl Cap
BNT2170	Ball Bearing	BNT3490	Idle Gear C	BNT3765	Handle Nut Plate
BNT2179	Screw	BNT3491	Worm Shaft	BNT5306	Spool Tension Spring
BNT2213	Clutch Cam Retainer	BNT3493	Stabilizer Bar		
BNT2224	Spool Tension Spacer	BNT3498	Screw		
BNT2396	Roller Clutch Bearing	BNT3503	Level Wind Guard	BNT2575	Brake Collar (gray) (accessory)
BNT2404	Anti-Reverse Pawl	BNT3504	Spool Assembly	BNT3237	Wrench (accessory)

(151025)