

SHIMANO

CITICA

CI-200D

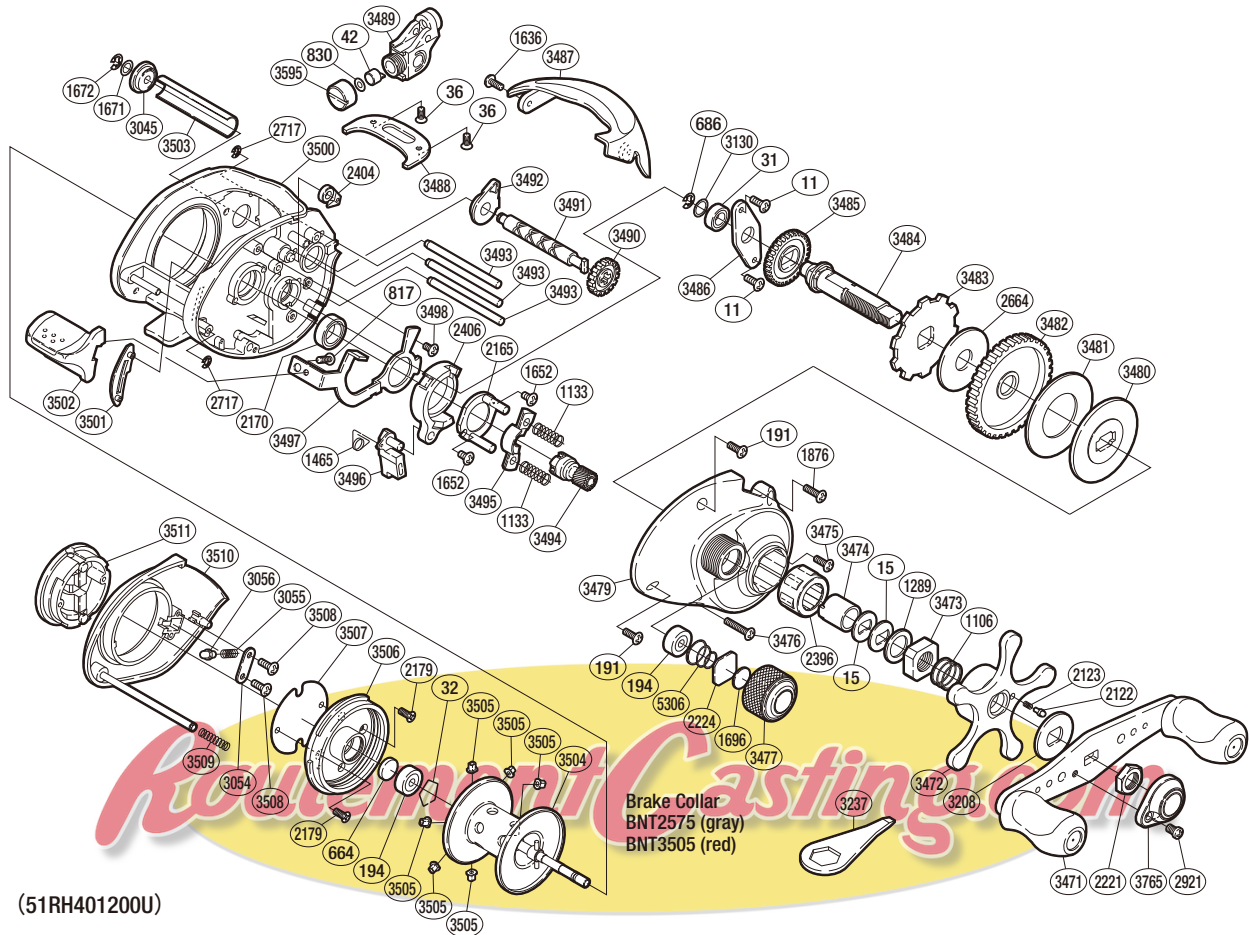

(51RH401200U)

| Part No. | Description | Part No. | Description | Part No. | Description |
|----------|----------------------|----------|--------------------------|----------|---------------------------------|
| BNT0011 | Screw | BNT2396 | Roller Clutch Bearing | BNT3489 | Line Guide |
| BNT0015 | Drag Spring Washer | BNT2404 | Anti-Reverse Pawl | BNT3490 | Idle Gear C |
| BNT0031 | Ball Bearing | BNT2406 | Clutch Cam | BNT3491 | Worm Shaft |
| BNT0032 | Bearing Retainer | BNT2664 | Drag Washer | BNT3492 | Worm Bushing A |
| BNT0036 | Screw | BNT2717 | E Lock | BNT3493 | Stabilizer Bar |
| BNT0042 | Line Guide Pawl | BNT2921 | Screw | BNT3494 | Pinion Gear |
| BNT0191 | Screw | BNT3045 | Worm Bushing B | BNT3495 | Yoke |
| BNT0194 | Ball Bearing | BNT3054 | Click Pin Retainer | BNT3496 | Clutch Pawl |
| BNT0664 | Spacer B | BNT3055 | Click Spring | BNT3497 | Clutch Plate |
| BNT0686 | E Lock | BNT3056 | Click Pin | BNT3498 | Screw |
| BNT0817 | Screw | BNT3130 | Washer | BNT3500 | One-Piece Frame |
| BNT0830 | Spacer | BNT3208 | Star Drag Click Plate | BNT3501 | Clutch Bar Guide |
| BNT1106 | Star Drag Spring | BNT3471 | Handle Assembly | BNT3502 | Quick-Fire II Clutch Bar |
| BNT1133 | Yoke Spring | BNT3472 | Star Drag | BNT3503 | Level Wind Guard |
| BNT1289 | Star Drag Spacer | BNT3473 | Star Drag Nut | BNT3504 | Spool Assembly |
| BNT1465 | Clutch Pawl Spring | BNT3474 | Roller Clutch Inner Tube | BNT3505 | Brake Collar (Red) |
| BNT1636 | Screw | BNT3475 | Screw | BNT3506 | Brake Case |
| BNT1652 | Screw | BNT3476 | Screw | BNT3507 | Brake Case Spacer |
| BNT1671 | Washer | BNT3477 | Cast Control Cap | BNT3508 | Screw |
| BNT1672 | E Lock | BNT3479 | Right Side Plate | BNT3509 | Side Plate Spring |
| BNT1696 | Cast Control Spacer | BNT3480 | Key Washer | BNT3510 | Left Side Plate |
| BNT1876 | Screw | BNT3481 | Drag Washer | BNT3511 | Turnkey Dial |
| BNT2122 | Click Pin | BNT3482 | Drive Gear | BNT3595 | Pawl Cap |
| BNT2123 | Click Spring | BNT3483 | Anti-Reverse Ratchet | BNT3765 | Handle Nut Plate |
| BNT2165 | Clutch Cam Retainer | BNT3484 | Drive Shaft | BNT5306 | Spool Tension Spring |
| BNT2170 | Ball Bearing | BNT3485 | Idle Gear A | | |
| BNT2179 | Screw | BNT3486 | Drive Shaft Retainer | | |
| BNT2221 | Handle Nut | BNT3487 | Thumb Rest | BNT2575 | Brake Collar (gray) (accessory) |
| BNT2224 | Spool Tension Spacer | BNT3488 | Line Guard | BNT3237 | Wrench (accessory) |

(151025)