

Sonora™

2000F 01

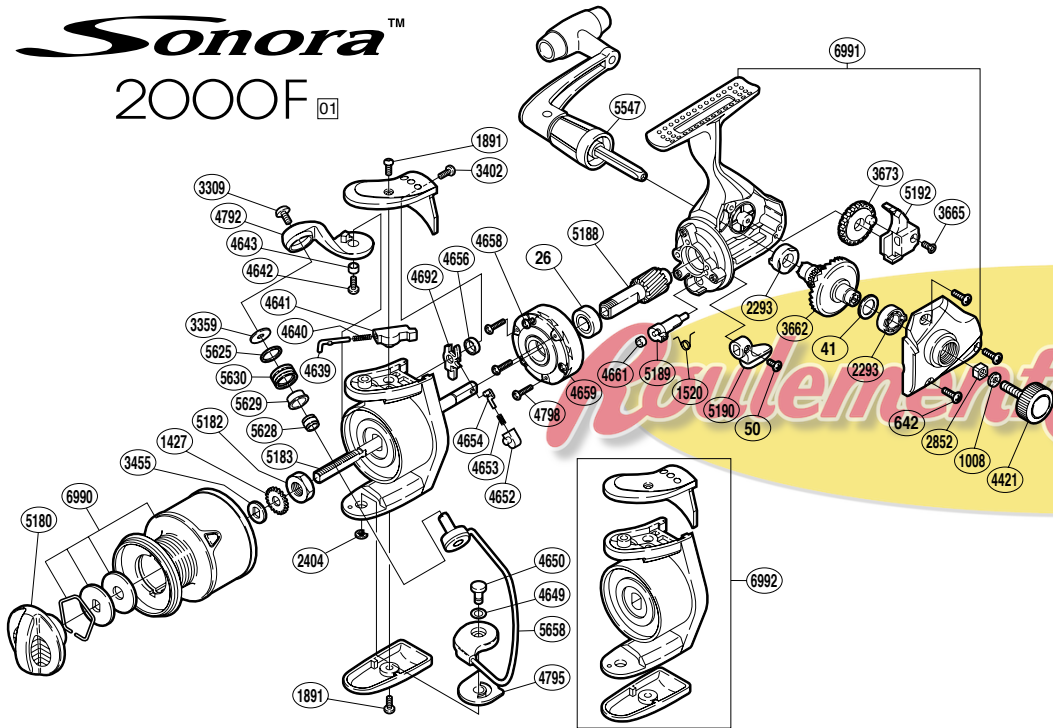

| RD No. | PARTS NAMES | RD No. | PARTS NAMES | RD No. | PARTS NAMES |
|--------|---------------------------------|--------|--------------------------|--------|---------------------|
| 0026 | Ball Bearing | 4421 | Handle Screw Cap | 4798 | Roller Clutch Screw |
| 0041 | Drive Gear Washer | 4639 | Bail Spring Guide (A) | 5180 | Drag Knob |
| 0050 | Anti-Reverse Lever Screw | 4640 | Bail Spring | 5182 | Rotor Nut |
| 0642 | Side Cover Screw | 4641 | Bail Spring Guide (B) | 5183 | Main Shaft |
| 1008 | Handle Lock Washer | 4642 | Bail Arm Screw | 5188 | Pinion Gear |
| 1427 | Spool Support | 4643 | Bail Arm Bushing | 5189 | Anti-Reverse Cam |
| 1520 | Anti-Reverse Cam Spring | 4649 | Spacer | 5190 | Anti-Reverse Lever |
| 1891 | Multi-Purpose Screw | 4650 | Bail Hold Support Shaft | 5192 | Oscillating Slider |
| 2293 | Drive Gear Bushing | 4652 | Lever Spring Guide (B) | 5547 | Handle Assembly |
| 2404 | "E" Lock | 4653 | Lever Spring | 5625 | Line Roller Spacer |
| 2852 | Handle Screw Lock | 4654 | Lever Spring Guide (A) | 5628 | Line Roller Collar |
| 3309 | Line Roller Screw | 4656 | Trip Lever Spacer | 5629 | Line Roller Bushing |
| 3359 | Line Roller Washer | 4658 | Clutch Cover Screw | 5630 | Line Roller |
| 3402 | Bail Spring Cover Screw (small) | 4659 | Roller Clutch Assembly | 5658 | Bail Assembly |
| 3455 | Spool Washer | 4661 | Anti-Reverse Cam Ring | 6990 | Spool Assembly |
| 3662 | Drive Gear | 4692 | Bail Trip Lever | 6991 | Body Assembly |
| 3665 | Slider Retainer Screw | 4792 | Bail Arm | 6992 | Rotor Assembly |
| 3673 | Oscillating Gear | 4795 | Bail Hold Support Spacer | | |