

# SEDONA

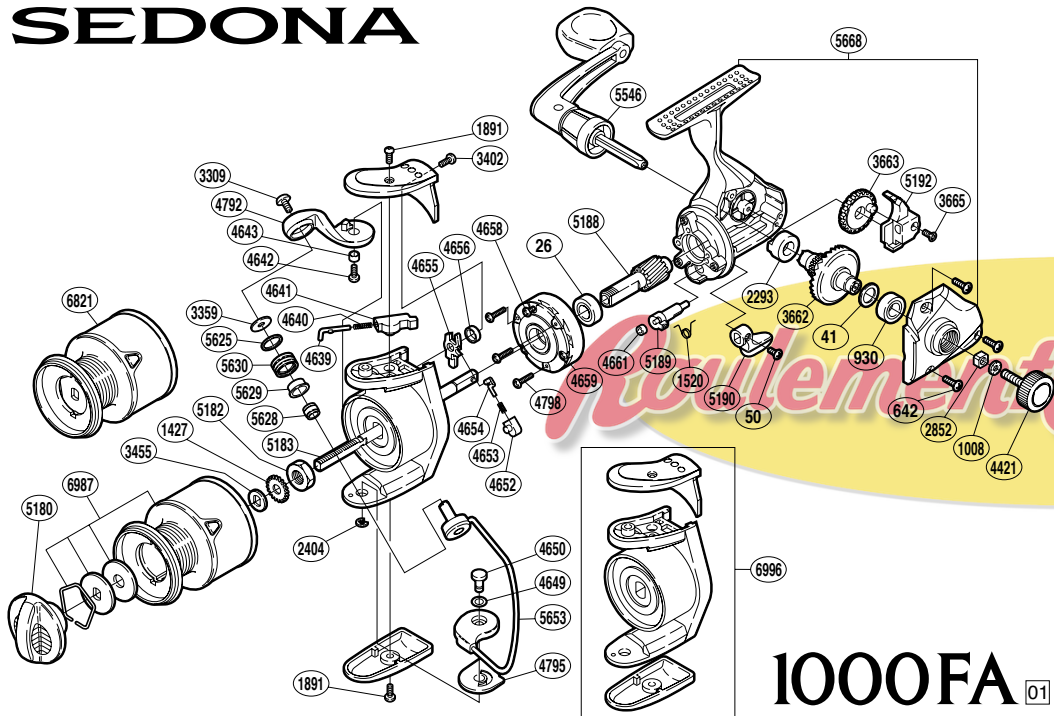

**1000FA** 01

| RD No. | PARTS NAMES                     | RD No. | PARTS NAMES              | RD No. | PARTS NAMES               |
|--------|---------------------------------|--------|--------------------------|--------|---------------------------|
| 0026   | Ball Bearing                    | 4421   | Handle Screw Cap         | 5180   | Drag Knob                 |
| 0041   | Drive Gear Washer               | 4639   | Bail Spring Guide (A)    | 5182   | Rotor Nut                 |
| 0050   | Anti-Reverse Lever Screw        | 4640   | Bail Spring              | 5183   | Main Shaft                |
| 0642   | Side Cover Screw                | 4641   | Bail Spring Guide (B)    | 5188   | Pinion Gear               |
| 0930   | Ball Bearing                    | 4642   | Bail Arm Screw           | 5189   | Anti-Reverse Cam          |
| 1008   | Handle Lock Washer              | 4643   | Bail Arm Bushing         | 5190   | Anti-Reverse Lever        |
| 1427   | Spool Support                   | 4649   | Spacer                   | 5192   | Oscillating Slider        |
| 1520   | Anti-Reverse Cam Spring         | 4650   | Bail Hold Support Shaft  | 5546   | Handle Assembly           |
| 1891   | Multi-Purpose Screw             | 4652   | Lever Spring Guide (B)   | 5625   | Line Roller Spacer        |
| 2293   | Drive Gear Bushing              | 4653   | Lever Spring             | 5628   | Line Roller Collar        |
| 2404   | "E" Lock                        | 4654   | Lever Spring Guide (A)   | 5629   | Line Roller Bushing       |
| 2852   | Handle Screw Lock               | 4655   | Bail Trip Lever          | 5630   | Line Roller               |
| 3309   | Line Roller Screw               | 4656   | Trip Lever Spacer        | 5653   | Bail Assembly             |
| 3359   | Line Roller Washer              | 4658   | Clutch Cover Screw       | 5668   | Body Assembly             |
| 3402   | Bail Spring Cover Screw (small) | 4659   | Roller Clutch Assembly   | 6821   | Spool Assembly (graphite) |
| 3455   | Spool Washer                    | 4661   | Anti-Reverse Cam Ring    | 6987   | Spool Assembly (aluminum) |
| 3662   | Drive Gear                      | 4792   | Bail Arm                 | 6996   | Rotor Assembly            |
| 3663   | Oscillating Gear                | 4795   | Bail Hold Support Spacer |        |                           |
| 3665   | Slider Retainer Screw           | 4798   | Roller Clutch Screw      |        |                           |