

SHIMANO

CALCUTTA TE

CTE-401

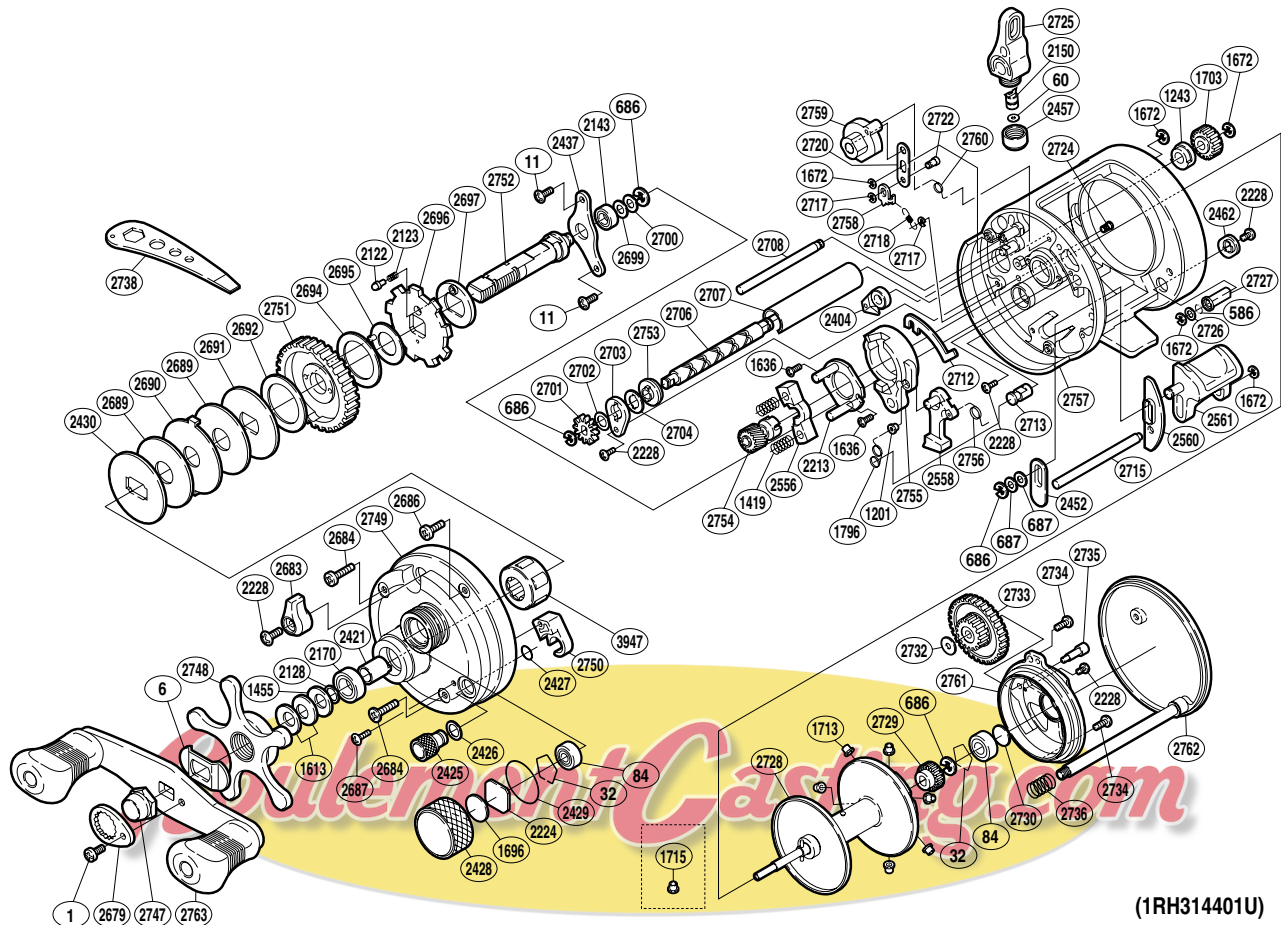

(1RH314401U)

| Part No. | Description | Part No. | Description | Part No. | Description |
|----------|----------------------------|----------|---------------------------|----------|-------------------------|
| BNT0001 | Handle Nut Plate Screw | BNT2430 | Key Washer | BNT2720 | Click Link |
| BNT0006 | Friction Washer (A) | BNT2437 | Drive Shaft Retainer | BNT2722 | Click Link Pin |
| BNT0011 | Drive Shaft Retainer Screw | BNT2446 | Yoke | BNT2724 | Click Spring Pin |
| BNT0032 | Bearing Retainer | BNT2449 | Clutch Pawl | BNT2725 | Line Guide |
| BNT0060 | Spacer (optional) | BNT2452 | Clutch Bar Guide (A) | BNT2726 | Damper Washer |
| BNT0084 | Ball Bearing | BNT2454 | Clutch Bar Guide (B) | BNT2727 | Damper (A) |
| BNT0586 | Bolt Retainer | BNT2457 | Pawl Cap | BNT2728 | Spool Assembly |
| BNT0686 | Click Pawl Retainer | BNT2462 | Damper Guide | BNT2729 | Idle Gear (A) |
| BNT0687 | Click Pawl Spacer | BNT2561 | Quick-Fire II Clutch Bar | BNT2730 | Spacer (B) |
| BNT1201 | Retractor Spring Collar | BNT2679 | Handle Nut Plate | BNT2732 | Idle Gear "B" Washer |
| BNT1243 | Worm Bushing (B) | BNT2683 | Click Switch | BNT2733 | Idle Gear "B" |
| BNT1419 | Yoke Spring | BNT2684 | Left Side Plate Screw (A) | BNT2734 | Brake Case Screw |
| BNT1455 | Drag Spring Washer (H) | BNT2686 | Left Side Plate Screw (B) | BNT2735 | Idle Gear Shaft |
| BNT1613 | Drag Spring Washer (L) | BNT2687 | Cam Backing Plate Screw | BNT2736 | Right Side Plate Spring |
| BNT1636 | Clutch Cam Screw | BNT2689 | Drag Washer (A) | BNT2747 | Handle Nut |
| BNT1672 | "E" Lock | BNT2690 | Key Washer (B) | BNT2748 | Star Drag |
| BNT1696 | Cast Control Spacer (B) | BNT2691 | Base Drag Disc | BNT2749 | Left Side Plate |
| BNT1703 | Idle Gear (C) | BNT2692 | Drag Washer (C) | BNT2750 | Cam Backing Plate |
| BNT1713 | Brake Collar (green) | BNT2694 | Drag Washer (A) | BNT2751 | Drive Gear |
| BNT1796 | Retractor Spring | BNT2695 | Drag Click Plate | BNT2752 | Drive Shaft |
| BNT2122 | Drag Click Pin | BNT2696 | Anti-Reverse Ratchet | BNT2753 | Worm Bushing (A) |
| BNT2123 | Drag Click Spring | BNT2697 | Drag Click Pin Holder | BNT2754 | Worn Gear (A) |
| BNT2128 | Bearing Washer | BNT2699 | Drive Shaft Washer (A) | BNT2755 | Clutch Cam |
| BNT2143 | Ball Bearing | BNT2700 | Drive Shaft Washer (B) | BNT2756 | Clutch Pawl Spring |
| BNT2150 | Line Guide Pawl | BNT2701 | Click Gear | BNT2757 | One-Piece Frame |
| BNT2165 | Clutch Cam Retainer | BNT2702 | Worm Shaft Washer (B) | BNT2758 | Click Pawl |
| BNT2170 | Star Drag Bearing | BNT2703 | Worm Bushing (A) Retainer | BNT2759 | Click Switch Cam |
| BNT2224 | Spool Tension Spacer (A) | BNT2704 | Worm Shaft Washer (A) | BNT2760 | Click Switch Spring |
| BNT2228 | Clutch Cam Screw | BNT2706 | Worm Shaft | BNT2761 | Brake Case |
| BNT2404 | Anti-Reverse Pawl | BNT2707 | Level Wind Guard | BNT2762 | Right Side Plate |
| BNT2421 | Roller Clutch Inner Tube | BNT2708 | Level Wind Guide | BNT2763 | Handle Assembly |
| BNT2425 | Side Plate Open Nut | BNT2712 | Clutch Plate | BNT3947 | Roller Clutch Bearing |
| BNT2426 | Open Nut Washer | BNT2713 | Retractor Spring Pin | | |
| BNT2427 | "O" Ring | BNT2715 | Clutch Bar Support | BNT1715 | Brake Collar (red) |
| BNT2428 | Cast Control Cap | BNT2717 | "E" Lock | | |
| BNT2429 | "O" Ring | BNT2718 | Click Spring | BNT2738 | Wrench (accessory) |

(210703)