

TWIN POWER 6000F

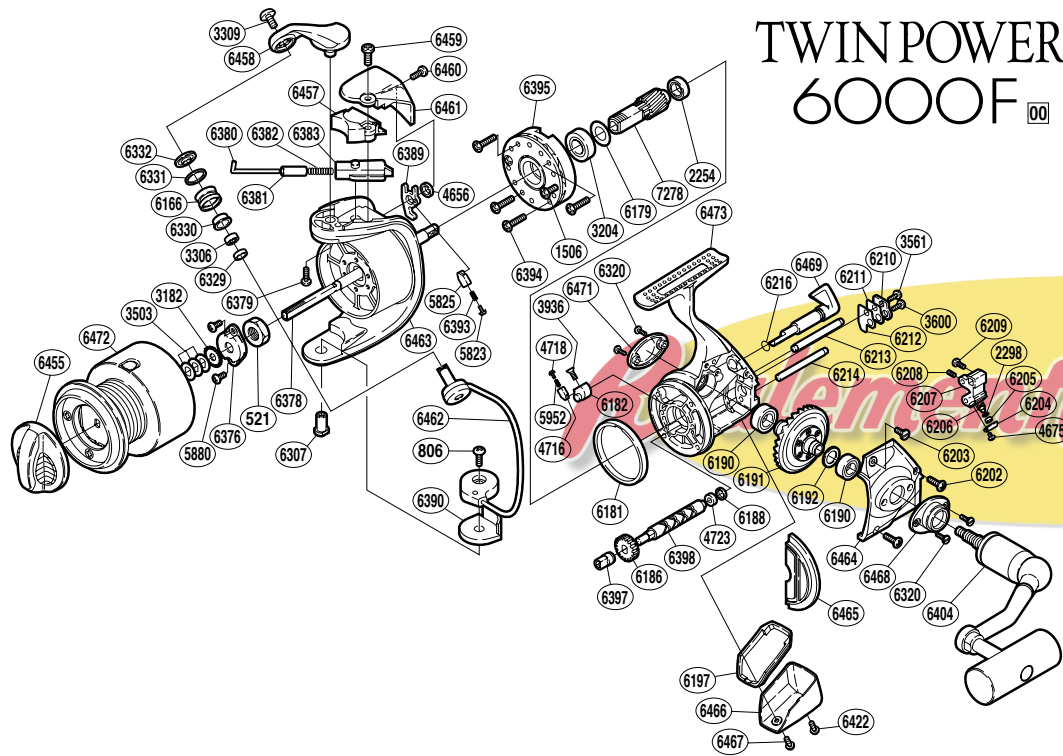

RD No.	PARTS NAMES	RD No.	PARTS NAMES	RD No.	PARTS NAMES
0521	Rotor Nut	6191	Drive Gear	6383	Bail Spring Guide (B)
0806	Bail Hold Support Screw	6192	Drive Gear Washer	6389	Bail Trip Lever
1506	Clutch Cover Screw	6197	Rear Shield	6390	Bail Hold Support Spacer
2254	Ball Bearing	6202	Side Cover Screw (long)	6393	Lever Spring
2298	Spacer	6203	Side Cover Screw (short)	6394	Roller Clutch Screw
3182	Spool Support	6204	Oscillating Pawl Cover	6395	Roller Clutch Assembly
3204	Ball Bearing	6205	Oscillating Slider Bushing	6397	Worm Bushing (front)
3306	Ball Bearing	6206	Oscillating Pawl	6398	Worm Shaft
3309	Line Roller Screw	6207	Oscillating Slider	6404	Handle Assembly
3503	Spool Washer	6208	Set Screw	6422	Rear Protector Screw (A)
3561	Worm Shaft Retainer Screw (small)	6209	Slider Retainer Screw	6455	Drag Knob
3600	Worm Shaft Retainer Screw (large)	6210	Worm Shaft Retainer Spacer	6457	Bail Spring Cover
3936	Anti-Reverse Cam Screw	6211	Worm Shaft Retainer	6458	Bail Arm
4656	Trip Lever Spacer	6212	Worm Shaft Retainer Washer	6459	Protector Screw (A)
4675	Oscillating Pawl Cover Screw	6213	Oscillating Guide (A)	6460	Protector Screw (B)
4716	Lever Spring Guide (B)	6214	Oscillating Guide (B)	6461	Rotor Protector
4718	Lever Spring Guide (A)	6216	"O" Ring	6462	Bail Assembly
4723	Worm Bushing Rear	6307	Bail Hold Support Shaft	6463	Rotor
5823	Lever Spring Guide (A)	6320	Cap Screw	6464	Side Cover
5825	Lever Spring Guide (B)	6329	Bearing Spacer	6465	Side Cover Flange
5880	Nut Lock Screw	6330	Line Roller Bushing	6466	Rear Protector
5925	Bail Trip Lever Spring	6331	Line Roller Spacer	6467	Rear Protector Screw (B)
6166	Line Roller	6332	Line Roller Washer	6468	Handle Screw Cap (A)
6179	Bearing Washer	6376	Rotor Nut Lock Plate	6469	Anti-Reverse Lever
6181	Friction Ring	6378	Main Shaft	6471	Handle Screw Cap (B)
6182	Anti-Reverse Cam	6379	Bail Arm Screw	6472	Spool Assembly
6186	Idle Gear	6380	Bail Spring Guide (A)	6473	Body
6188	Worm Shaft Ring	6381	Spring Guide (A) Support	7278	Pinion Gear
6190	Ball Bearing	6382	Bail Spring		