

# SUSTAIN 1000FB 00

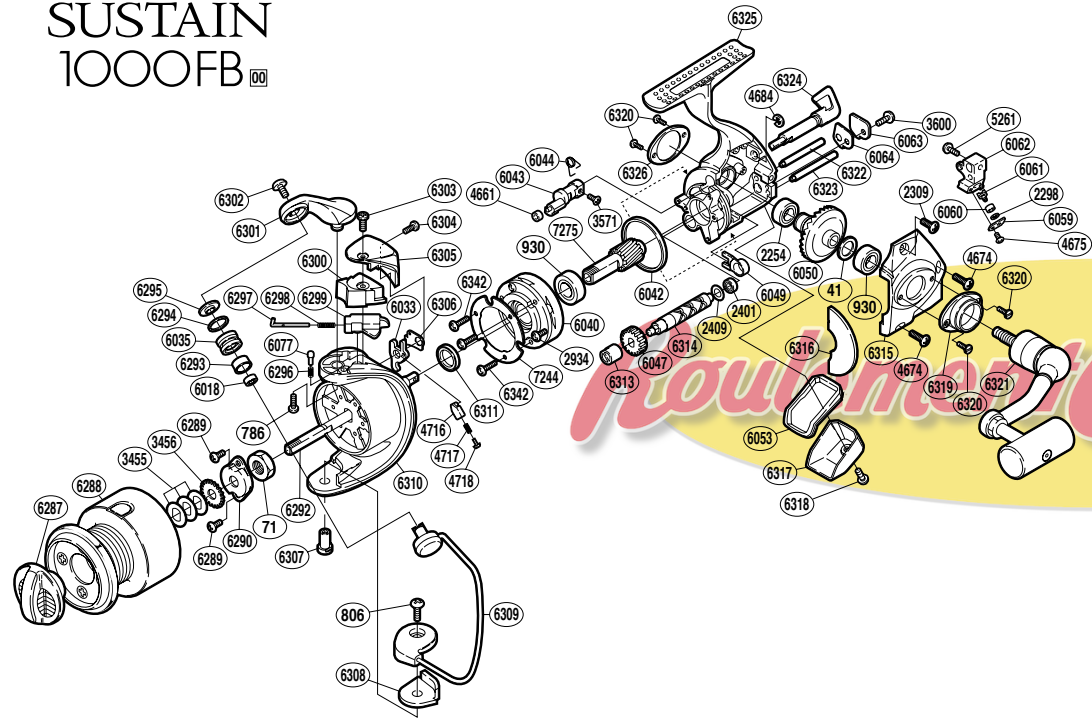

| RD No. | PARTS NAMES                  | RD No. | PARTS NAMES                | RD No. | PARTS NAMES              |
|--------|------------------------------|--------|----------------------------|--------|--------------------------|
| 0041   | Drive Gear Washer            | 6043   | Anti-Reverse Cam           | 6303   | Protector Screw (A)      |
| 0071   | Rotor Nut                    | 6044   | Anti-Reverse Cam Spring    | 6304   | Protector Screw (B)      |
| 0786   | Bail Arm Screw               | 6047   | Idle Gear                  | 6305   | Rotor Protector          |
| 0806   | Bail Hold Support Screw      | 6049   | Bushing                    | 6306   | Trip Lever Spacer        |
| 0930   | Ball Bearing                 | 6050   | Drive Gear                 | 6307   | Bail Hold Support Shaft  |
| 2254   | Ball Bearing                 | 6053   | Rear Shield                | 6308   | Bail Hold Support Spacer |
| 2298   | Spacer                       | 6059   | Oscillating Pawl Cover     | 6309   | Bail Assembly            |
| 2309   | Side Cover Screw (short)     | 6060   | Oscillating Slider Bushing | 6310   | Rotor                    |
| 2401   | Ball Bearing                 | 6061   | Oscillating Pawl           | 6311   | Rotor Spacer             |
| 2409   | Worm Shaft Spacer            | 6062   | Oscillating Slider         | 6313   | Worm Bushing             |
| 2934   | Clutch Cover Screw           | 6063   | Worm Shaft Retainer        | 6314   | Worm Shaft               |
| 3455   | Spool Washer                 | 6064   | Worm Shaft Retainer Washer | 6315   | Side Cover               |
| 3456   | Spool Support                | 6077   | Click Pin                  | 6316   | Side Cover Flange        |
| 3571   | Anti-Reverse Cam Screw       | 6287   | Drag Knob                  | 6317   | Rear Protector           |
| 3600   | Worm Shaft Retainer Screw    | 6288   | Spool Assembly             | 6318   | Rear Protector Screw     |
| 4661   | Anti-Reverse Cam Ring        | 6289   | Nut Lock Screw             | 6319   | Handle Screw Cap (A)     |
| 4674   | Side Cover Screw             | 6290   | Rotor Nut Lock Plate       | 6320   | Cap Screw                |
| 4675   | Oscillating Pawl Cover Screw | 6292   | Main Shaft                 | 6321   | Handle Assembly          |
| 4684   | "E" Lock                     | 6293   | Line Roller Bushing        | 6322   | Oscillating Guide (A)    |
| 4716   | Lever Spring Guide (B)       | 6294   | Line Roller Spacer         | 6323   | Oscillating Guide (B)    |
| 4717   | Lever Spring                 | 6295   | Line Roller Washer         | 6324   | Anti-Reverse Lever       |
| 4718   | Lever Spring Guide (A)       | 6296   | Click Spring               | 6325   | Body                     |
| 5261   | Slider Retainer Screw        | 6297   | Bail Spring Guide (A)      | 6326   | Handle Screw Cap (B)     |
| 6018   | Ball Bearing                 | 6298   | Bail Spring                | 6342   | Roller Clutch Screw      |
| 6033   | Bail Trip Lever              | 6299   | Bail Spring Guide (B)      | 7244   | Roller Clutch Reinforce  |
| 6035   | Line Roller                  | 6300   | Bail Spring Cover          | 7275   | Pinion Gear              |
| 6040   | Roller Clutch Assembly       | 6301   | Bail Arm                   |        |                          |
| 6042   | Friction Ring                | 6302   | Line Roller Screw          |        |                          |