

SOLSTACE

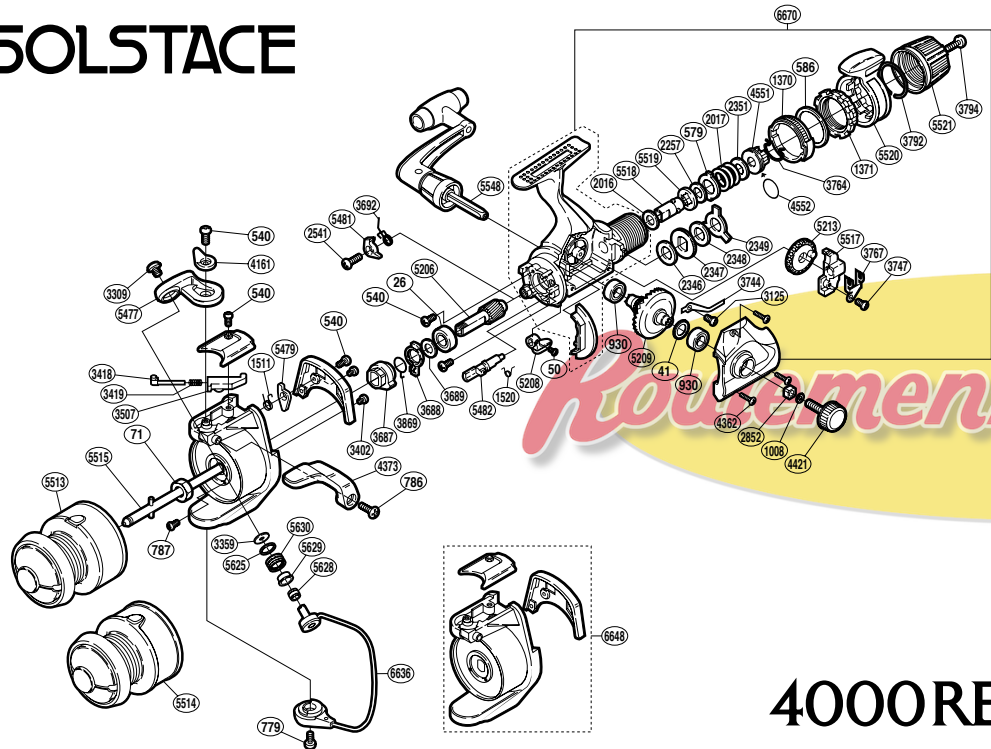

4000RE 00

RD No.	PARTS NAMES	RD No.	PARTS NAMES	RD No.	PARTS NAMES
0026	Ball Bearing	2852	Handle Screw Lock	5206	Pinion Gear
0041	Drive Gear Washer	3125	Drag Click Screw	5208	Anti-Reverse Lever
0050	Anti-Reverse Lever Screw	3309	Line Roller Screw	5209	Drive Gear
0071	Rotor Nut	3359	Line Roller Washer	5213	Oscillating Gear
0540	Multi-Purpose Screw	3402	Cover Screw	5477	Bail Arm
0579	Eared Washer "B"	3418	Bail Spring Guide (A)	5479	Bail Trip Lever
0586	Fightin' Pressure Screw Washer	3419	Bail Spring	5481	Anti-Reverse Pawl
0779	Bail Hold Support Screw	3507	Bail Spring Guide (B)	5482	Anti-Reverse Cam
0786	Trigger Screw	3687	Anti-Reverse Ratchet	5513	Spool Assembly (aluminum)
0787	Nut Lock Screw	3688	Anti-Reverse Lock Out	5514	Spool Assembly (graphite)
0930	Ball Bearing	3689	Bushing Washer	5515	Main Shaft
1008	Handle Lock Washer	3692	Anti-Reverse Pawl Spring	5517	Oscillating Slider
1370	Lever Click Gaer	3744	Drag Click	5518	Drag Shaft (A)
1371	Fightin' Pressure Screw	3747	Slider Retainer Screw	5519	Drag Shaft (B)
1511	Lever Spring	3764	Hold Click Spring	5520	Fightin' Drag Lever
1520	Anti-Reverse Cam Spring	3767	Oscillating Slider Retainer	5521	Drag Programmer
2016	Drag Washer "H" (cloth)	3792	Lever Hold Spring	5548	Handle Assembly
2017	Drag Coil Spring	3794	Drag Programmer Screw	5625	Line Roller Spacer
2257	Drag Washer "H" (blue)	3869	Anti-Reverse Lock Out Spring	5628	Line Roller Collar
2346	Drag Washer "C" (cloth)	4161	Trigger Cam	5629	Line Roller Bushing
2347	Click Gear	4362	Side Cover Screw	5630	Line Roller
2348	Drag Washer "C" (blue)	4373	Quick-Fire II Trigger	6636	Bail Assembly
2349	Eared Washer "B"	4421	Handle Screw Cap	6648	Rotor Assembly
2351	Drag Spring Washer	4551	Pressure Screw	6670	Body Assembly
2541	Anti-Reverse Pawl Screw	4552	"O" Ring		

(110714)