

KX

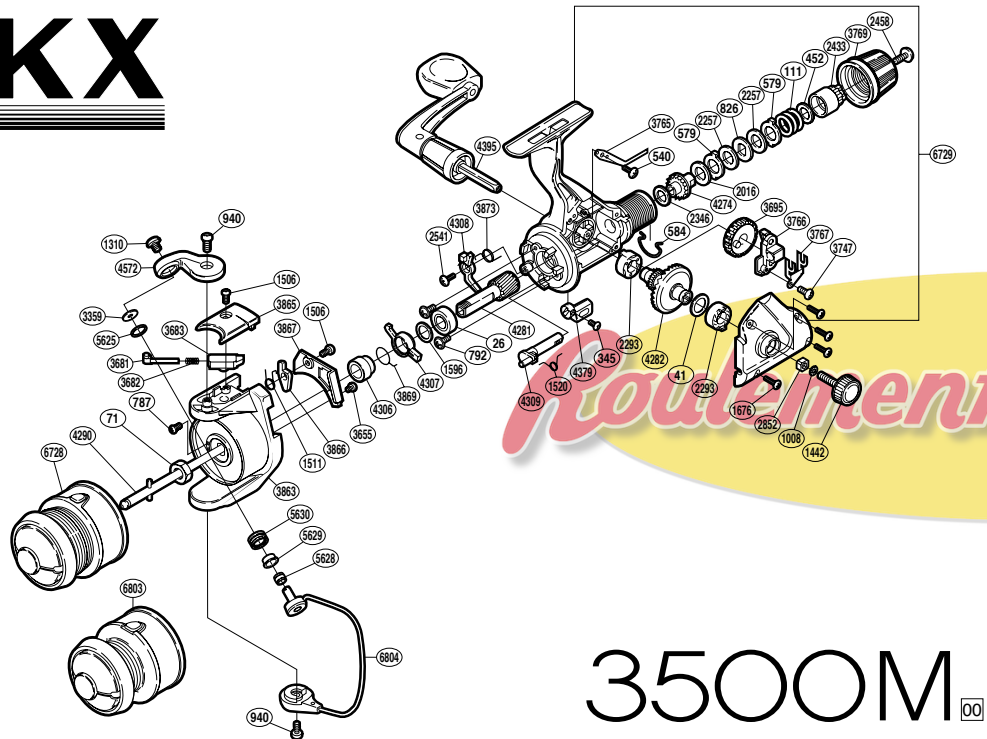

3500M 00

| RD No. | PARTS NAMES | RD No. | PARTS NAMES | RD No. | PARTS NAMES |
|--------|--------------------------|--------|-----------------------------|--------|------------------------------|
| 0026 | Ball Bearing | 2257 | Drag Washer "H" (blue) | 3869 | Anti-Reverse Lock Out Spring |
| 0041 | Drive Gear Washer | 2293 | Drive Gear Bushing | 3873 | Anti-Reverse Pawl Spring |
| 0071 | Rotor Nut | 2346 | Drag Washer "C" (cloth) | 4274 | Drag Shaft |
| 0111 | Drag Coil Spring | 2433 | Pressure Screw | 4281 | Pinion Gear |
| 0345 | Anti-Reverse Lever Screw | 2458 | Drag Knob Screw | 4282 | Drive Gear |
| 0452 | Drag Spring Washer | 2541 | Anti-Reverse Pawl Screw | 4290 | Main Shaft |
| 0540 | Drag Click Screw | 2852 | Handle Screw Lock | 4306 | Lock Out Spring Holder |
| 0579 | Eared Washer "B" | 3359 | Line Roller Washer | 4307 | Anti-Reverse Lock Out |
| 0584 | Hold Click Spring | 3655 | Cover Screw | 4308 | Anti-Reverse Pawl |
| 0787 | Nut Lock Screw | 3681 | Bail Spring Guide (A) | 4309 | Anti-Reverse Cam |
| 0792 | Bearing Retainer Screw | 3682 | Bail Spring | 4379 | Anti-Reverse Lever |
| 0826 | Key Washer "A" | 3683 | Bail Spring Guide (B) | 4395 | Handle Assembly |
| 0940 | Multi-Purpose Screw | 3695 | Oscillating Gear | 4572 | Bail Arm |
| 1008 | Handle Lock Washer | 3747 | Slider Retainer Screw | 5625 | Line Roller Spacer |
| 1310 | Line Roller Screw | 3765 | Drag Click | 5628 | Line Roller Collar |
| 1442 | Handle Screw Cap | 3766 | Oscillating Slider | 5629 | Line Roller Bushing |
| 1506 | Multi-Purpose Screw | 3767 | Oscillating Slider Retainer | 5630 | Line Roller |
| 1511 | Lever Spring | 3769 | Drag Knob | 6728 | Spool Assembly |
| 1520 | Anti-Reverse Cam Spring | 3863 | Rotor | 6729 | Body Set |
| 1596 | Bushing Washer | 3865 | Bail Spring Cover | 6803 | Spare Spool Assembly |
| 1676 | Side Cover Screw | 3866 | Bail Trip Lever | 6804 | Bail Assembly |
| 2016 | Drag Washer "H" (cloth) | 3867 | Counterbalance Cover | | |

(111216)