

# Calyx

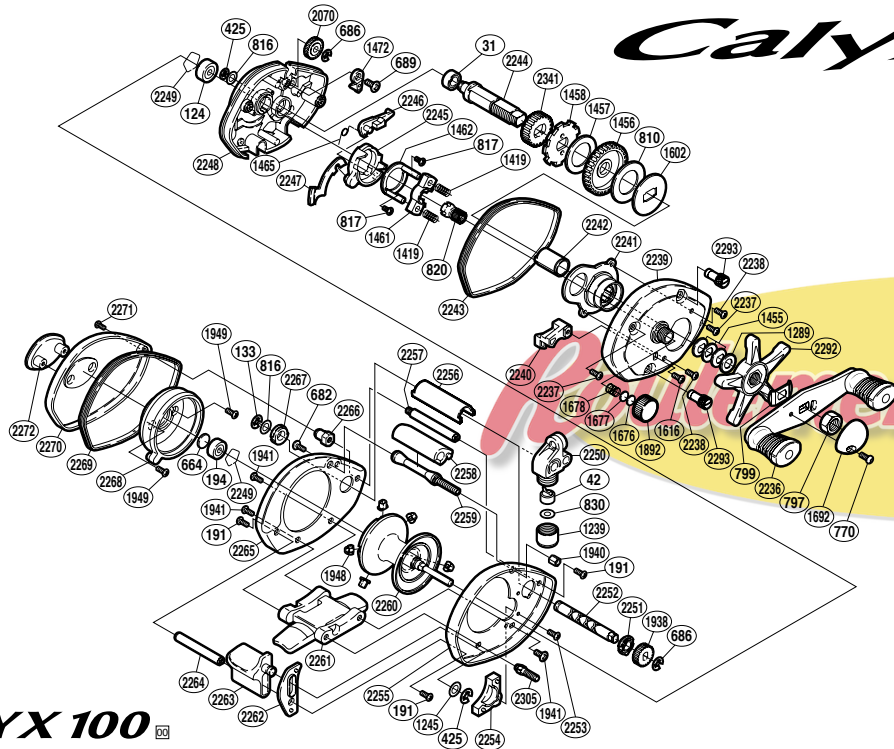

**CYX 100** BB

BNT No.	PARTS NAMES	BNT No.	PARTS NAMES	BNT No.	PARTS NAMES
0031	Ball Bearing	1465	Clutch Pawl Spring	2250	Line Guide
0042	Line Guide Pawl	1472	Anti-Reverse Pawl	2251	Worm Bushing (A)
0124	Ball Bearing	1602	Key Washer	2252	Worm Shaft
0133	Worm Shaft Retainer	1616	Return Pin Guide Screw	2253	Drive Shaft Cover Screw
0191	Multi-Purpose Screw	1676	Spool Tension Spacer (B)	2254	Drive Shaft Cover
0194	Ball Bearing	1677	Spool Tension Spacer (A)	2255	A-Side Frame
0425	"E" Lock	1678	Spool Tension Spring	2256	Level Wind Guard
0664	Spacer (B)	1692	Handle Nut Plate	2257	Stabilizer Bar
0682	Frame Bar (A) Screw	1892	Cast Control Cap	2258	Thumb Rest
0686	"E" Lock	1938	Idle Gear (C)	2259	Frame Bar (A)
0689	Anti-Reverse Pawl Screw	1940	Frame Nut	2260	Spool Assembly
0770	Handle Nut Plate Screw	1941	Stand Screw	2261	Stand
0797	Handle Nut	1948	Brake Collar	2262	Clutch Button Guide
0799	Friction Washer	1949	I.D.Plate Screw	2263	Quick-Fire II Clutch Button
0810	Drag Washer	2070	Idle Gear (B)	2264	Clutch Button Support Bar
0816	Shaft Washer	2236	Handle Assembly	2265	B-Side Frame
0817	Clutch Cam Retainer Screw	2237	Right Side Plate Screw	2266	B-Side Frame Nut
0820	Pinion Gear	2238	Bush Plate Screw	2267	Worm Bushing (B)
0830	Spacer (optional)	2239	Right Side Plate	2268	Brake Case
1239	Pawl Cap	2240	Return Pin Guide	2269	B-Side Seal
1245	Clutch Bar Support Spacer	2241	Roller Clutch Assembly	2270	Left Side Plate
1289	Star Drag Spacer	2242	Roller Clutch Inner Tube	2271	Left Side Plate Screw
1419	Yoke Spring	2243	A-Side Seal	2272	Left Side I.D.Plate
1455	Drag Spring Washer	2244	Drive Shaft	2292	Star Drag
1456	Drive Gear	2245	Clutch Cam	2293	Right Side Plate Nut
1457	Drive Shaft Washer (B)	2246	Clutch Pawl	2305	Stand Bolt
1458	Anti-Reverse Ratchet	2247	Clutch Plate	2341	Idle Gear (A)
1461	Yoke	2248	Set Plate		
1462	Clutch Cam Retainer	2249	Bearing Retainer		

(110901)