

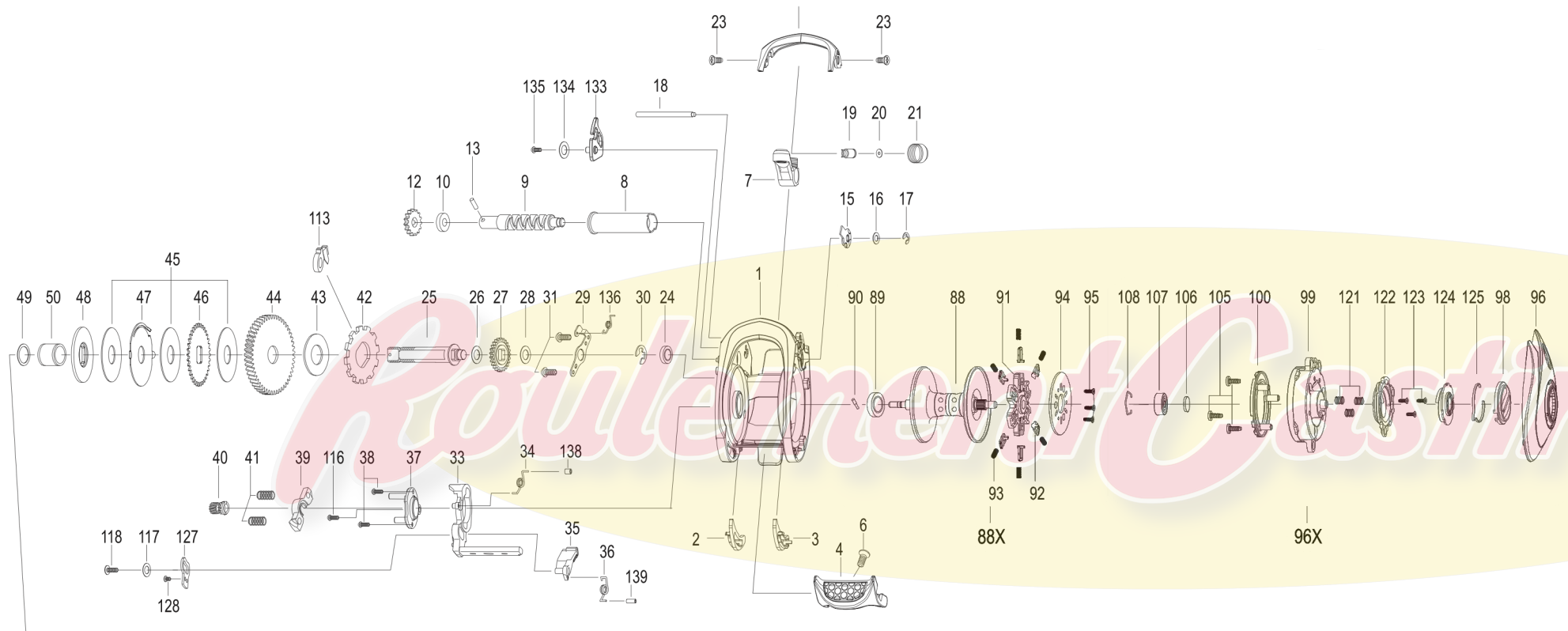

SUPERDUTY® 300 SERIES

SPEED SPOOL® LFS

SD3HL, SD3SHL, SD3SHLJ



KEY #	PART NAME	KEY #	PART NAME	KEY #	PART NAME
1	FRAME	46	DRAG WASHER (D1)	88X	SPOOL ASSEMBLY
2	CLUTCH BAR PLATE-R	47	DRAG WASHER (A)	89	BALL BEARING
3	CLUTCH BAR PLATE-L	48	DRAG WASHER (D2)	90	PIN
4	CLUTCH BAR ASSEMBLY	49	SLEEVE WASHER (OPTIONAL)	91	BRAKE HOLDER
6	CLUTCH BAR SCREW	50	SLEEVE	92	BRAKE SHOE
7	LEVEL WIND ASSEMBLY	51	GEAR SIDE PLATE	93	BRAKE SHOE SPRING
8	PIPE	51X	GEAR SIDE PLATE ASSEMBLY	94	MAGNET PLATE
9	WORM SHAFT	53	ONE-WAY CLUTCH	95	MAGNET PLATE SCREW
10	BALL BEARING	54	O-RING	96	PALM SIDE PLATE
12	IDLER(S)	55	BALL BEARING	96X	PALM SIDE PLATE ASSEMBLY
13	WORM SHAFT PIN	56	BEARING RETAINER	98	CONTROL DIAL
15	WORM SHAFT BUSHING (B)	57	CAST CONTROL CAP	99	SPOOL COVER
16	WORM SHAFT WASHER (OPTIONAL)	57X	CAST CONTROL CAP ASSEMBLY	100	MAGNET HOLDER ASSEMBLY
17	E-RING	58	CLICKER	105	SPOOL COVER SCREW (3)
18	PILLAR	59	CLICK PLATE	106	SPOOL SPACER (A)
19	LEVEL WIND PIN	60	CLICK PLATE RETAINER	107	BALL BEARING
20	SPACER (OPTIONAL)	61	TENSION WASHER	108	BEARING RETAINER
21	LEVEL WIND NUT	62	SPOOL SPACER (B)	114	WASHER (OPTIONAL)
22	FRONT COVER	66	GEAR SIDE PLATE SCREW (A)	117	CLUTCH WASHER
23	FRONT COVER SCREW (A)	67	GEAR SIDE PLATE SCREW (B)	118	CLUTCH SCREW
24	BALL BEARING	69	LUBE PORT CAP	121	SLIDE CAM SPRING
25	CRANK SHAFT	70	LUBE PORT CAP SCREW	122	SLIDE CAM (H)
26	IDLER (L) WASHER (A)	71	DRAG SPRING WASHER	123	SLIDE CAM SCREW
27	IDLER (L)	72	CLICK HOLDER	124	SLIDE CAM (D)
28	IDLER (L) WASHER (B)	73	STAR DRAG	125	CLICK SPRING
29	BEARING PLATE	73X	STAR DRAG ASSEMBLY	127	LINK PLATE
30	E-RING	74	CLICKER	128	LINK PLATE SCREW
31	BEARING PLATE SCREW	75	CLICK PLATE	133	SPEED KEEPER
33	CLUTCH CAM	76	CLICK PLATE RETAINER	134	SPEED KEEPER WASHER (OPT)
34	CLUTCH SPRING	77	HANDLE WASHER	135	SPEED KEEPER SCREW
35	KICK LEVER	78	HANDLE	136	SPEED KEEPER SPRING
36	KICK LEVER SPRING	78X	HANDLE ASSEMBLY	141	HOOD
37	CAM PLATE	79	BALL BEARING	142	HOOD SCREW
38	CAM PLATE SCREW	80	HANDLE KNOB	143	FRONT COVER SCREW (B)
39	PINION YOKE	81	BALL BEARING	144	LOCK LEVER
40	PINION GEAR	82	HANDLE KNOB SCREW	145	CLICK PIN SPRING
41	PINION YOKE SPRING (2)	83	HANDLE KNOB CAP	146	CLICK PIN
42	RATCHET	85	HANDLE NUT	147	GUIDE PIN
43	RATCHET WASHER	86	HANDLE NUT RETAINER	148	WASHER (OPTIONAL)
44	DRIVE GEAR	87	SCREW		
45	DRAG WASHER (L-3)	88	SPOOL		

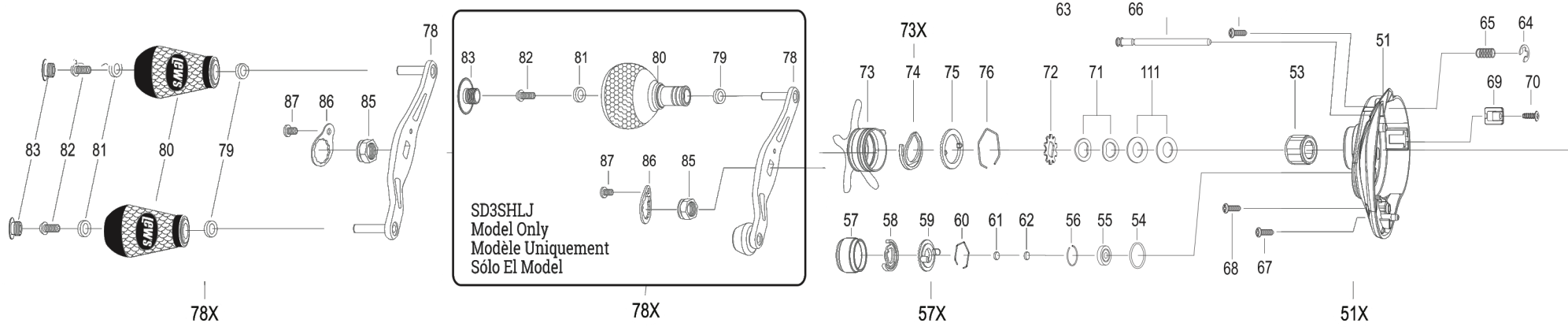

SD3SHLJ
Model Only
Modèle Uniquement
Sólo El Model