

LEW'S TEAM LEW'S PRO Z
SPEED SPOOL®
 TLP1HLZ, TLP1SHLZ

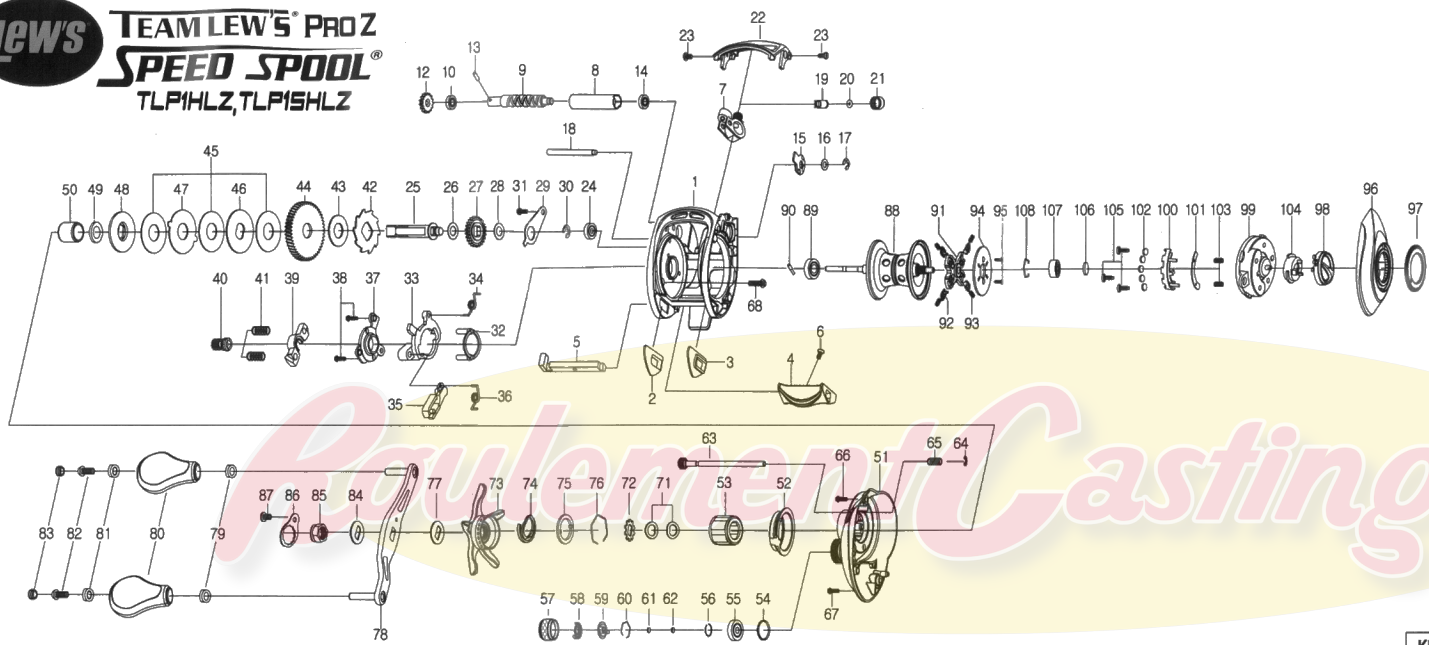

Paulsen Casting.com

KEY NO.	PARTS NAME	KEY NO.	PARTS NAME	KEY NO.	PARTS NAME	KEY NO.	PARTS NAME
1	FRAME	16	WORM SHAFT WASHER	30	E-RING	44	DRIVE GEAR
2	CLUTCH BAR PLATE (A)	17	E-RING	31	BEARING PLATE SCREW	45	DRAG WASHER (L*3)
3	CLUTCH BAR PLATE (B)	18	PILLAR	32	YOKE HOLDER	46	DRAG WASHER (D1)
4	CLUTCH BAR	19	LEVEL WIND PIN	33	CLUTCH CAM	47	DRAG WASHER (A)
5	CLUTCH LINK	20	SPACER(OPTIONAL)	34	CLUTCH SPRING	48	DRAG WASHER (D2)
6	CLUTCH BAR SCREW	21	LEVEL WIND NUT	35	KICK LEVER	49	SLEEVE WASHER (OPTIONAL)
7	LEVEL WIND ASSEMBLY	22	FRONT COVER	36	KICK LEVER SPRING	50	SLEEVE
8	PIPE	23	FRONT COVER SCREW (*2)	37	CAM PLATE	51	GEAR SIDE COVER ASSEMBLY
9	WORM SHAFT	24	BALL BEARING	38	CAM PLATE SCREW (*2)	52	GEAR SIDE COVER TRIM
10	BALL BEARING	25	CRANK SHAFT	39	PINION YOKE	53	ONE WAY CLUTCH
12	IDLER (S)	26	IDLER (L) WASHER (A)	40	PINION GEAR	54	O-RING
13	WORM SHAFT PIN	27	IDLER (L)	41	PINION YOKE SPRING (*2)	55	BALL BEARING
14	BALL BEARING	28	IDLER (L) WASHER (B)	42	RATCHET	56	C-RING
15	WORM SHAFT BUSHING (B)	29	BEARING PLATE	43	RATCHET WASHER	57	CAST CONTROL CAP

KEY NO.	PARTS NAME	KEY NO.	PARTS NAME
74	CLICKER	90	PIN
75	CLICK PLATE	91	BRAKE HOLDER
76	CLICK PLATE RETAINER	92	BRAKE SHOE (*4)
77	HANDLE WASHER	93	BRAKE SHOE SPRING (*4)
78	HANDLE ASSEMBLY	94	MAGNET PLATE
79	BALL BEARING (*2)	95	MAGNET PLATE SCREW (*2)
80	HANDLE KNOB ASSEMBLY (*2)	96	PALM SIDE COVER ASSEMBLY
81	BALL BEARING (*2)	97	PALM SIDE COVER TRIM
82	HANDLE KNOB SCREW (*2)	98	CONTROL DIAL ASSEMBLY
83	HANDLE KNOB CAP (*2)	99	SPOOL COVER
84	HANDLE WASHER	100	MAGNET HOLDER
85	HANDLE NUT	101	MAGNET HOLDER PLATE
86	HANDLE NUT RETAINER	102	MAGNET (*5)
87	HANDLE NUT RETAINER SCREW	103	MAGNET HOLDER SPRING (*2)
88	SPOOL ASSEMBLY	104	SLIDE CAM
89	BALL BEARING	105	SPOOL COVER SCREW (*3)
		106	SPOOL SPACER
		107	BALL BEARING
		108	BEARING RETAINER