

Lew's SUPERDUTY WIDE
SPEED SPOOL
 SDW2S, SDW2H, SDW2SH, SDW2XH

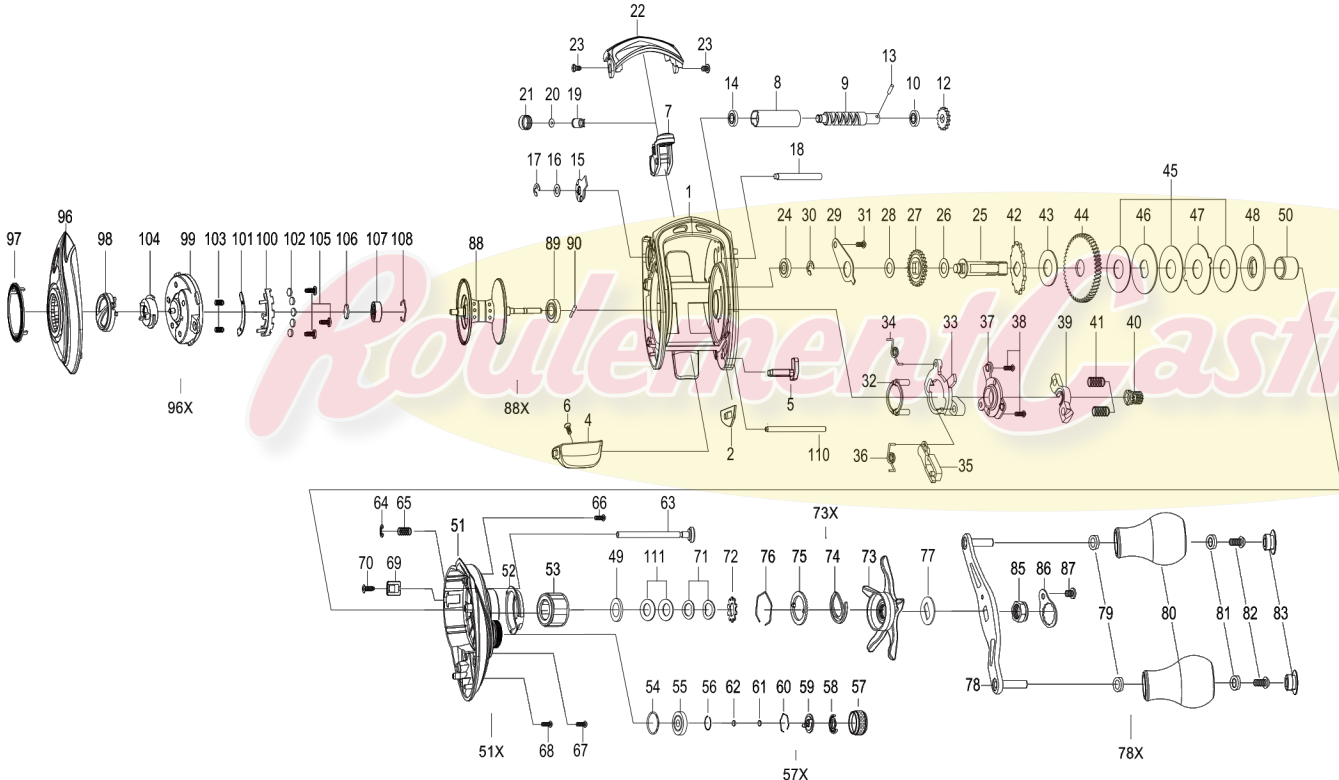

KEY #	PART NAME	KEY #	PART NAME	KEY #	PART NAME
1	FRAME	40	PINION GEAR	74	CLICKER
4	CLUTCH BAR	41	PINION YOKE SPRING (2)	75	CLICK PLATE
6	CLUTCH BAR SCREW	42	RATCHET	76	CLICK PLATE RETAINER
7	LEVELWIND ASSEMBLY	43	RATCHET WASHER	77	LEAF SPRING
8	PIPE	44	DRIVE GEAR	78	HANDLE
9	WORM SHAFT	45	DRAG WASHER (L-3)	78X	HANDLE ASSEMBLY
10	BALL BEARING	46	DRAG WASHER (D-1)	79	BUSHING
12	IDLER(S)	47	DRAG WASHER (A)	80	HANDLE KNOB
13	WORM SHAFT PIN	48	DRAG WASHER (D-2)	81	BALL BEARING (2)
15	WORM SHAFT BUSHING (B)	49	SLEEVE WASHER (OPTIONAL)	82	HANDLE KNOB SCREW
16	WORM SHAFT WASHER	50	SLEEVE	83	HANDLE KNOB CAP
17	E-RING	51	GEAR SIDEPLATE	85	HANDLE NUT
18	PILLAR	51X	GEAR SIDEPLATE ASSEMBLY	86	HANDLE NUT CAP
19	LEVELWIND PIN	53	ONE-WAY CLUTCH BEARING	87	SCREW
20	SPACER (OPTIONAL)	54	O-RING	88	SPOOL
21	LEVELWIND NUT	55	BALL BEARING	88X	SPOOL ASSEMBLY
22	FRONT COVER	56	BEARING RETAINER	89	BALL BEARING
23	FRONT COVER SCREW (2)	57	CAST CONTROL CAP	90	PIN
24	BALL BEARING	57X	CAST CONTROL CAP ASSEMBLY	96	PALMING SIDEPLATE
25	CRANK SHAFT	61	TENSION WASHER	96X	PALMING SIDEPLATE ASSEMBLY
26	IDLER (L) WASHER (A)	62	SPOOL SPACER (B)	97	PALMING SIDEPLATE TRIM
27	IDLER (L)	63	LOCKING PIN	98	CONTROL DIAL
28	IDLER(L) WASHER (B)	64	E-RING	99	SPOOL COVER
29	BEARING PLATE	65	LOCKING PIN SPRING	101	MAGNET HOLDER PLATE-F
30	E-RING	66	GEAR SIDEPLATE SCREW (A)	102	MAGNET (5)
31	BEARING PLATE SCREW	67	GEAR SIDEPLATE SCREW (B)	103	MAGNET HOLDER SPRING (2)
33	CLUTCH CAM	68	GEAR SIDEPLATE SCREW (C)	103	SLIDE CAM-F
34	CLUTCH SPRING	69	LUBE PORT	105	SPOOL COVER SCREW (3)
35	KICK LEVER	70	LUBE PROT SCREW	106	SPOOL SPACER-A
36	KICK LEVER SPRING	71	DRAG SPRING WASHER (A-2)	107	BALL BEARING
37	CLUTCH LINK	72	DRAG SPACER	108	BEARING RETAINER
38	CLUTCH LINK SCREW	73	STAR DRAG	124	SLIDE CAM-D
39	PINION YOKE	73X	STAR DRAG ASSEMBLY	125	CLICK SPRING