

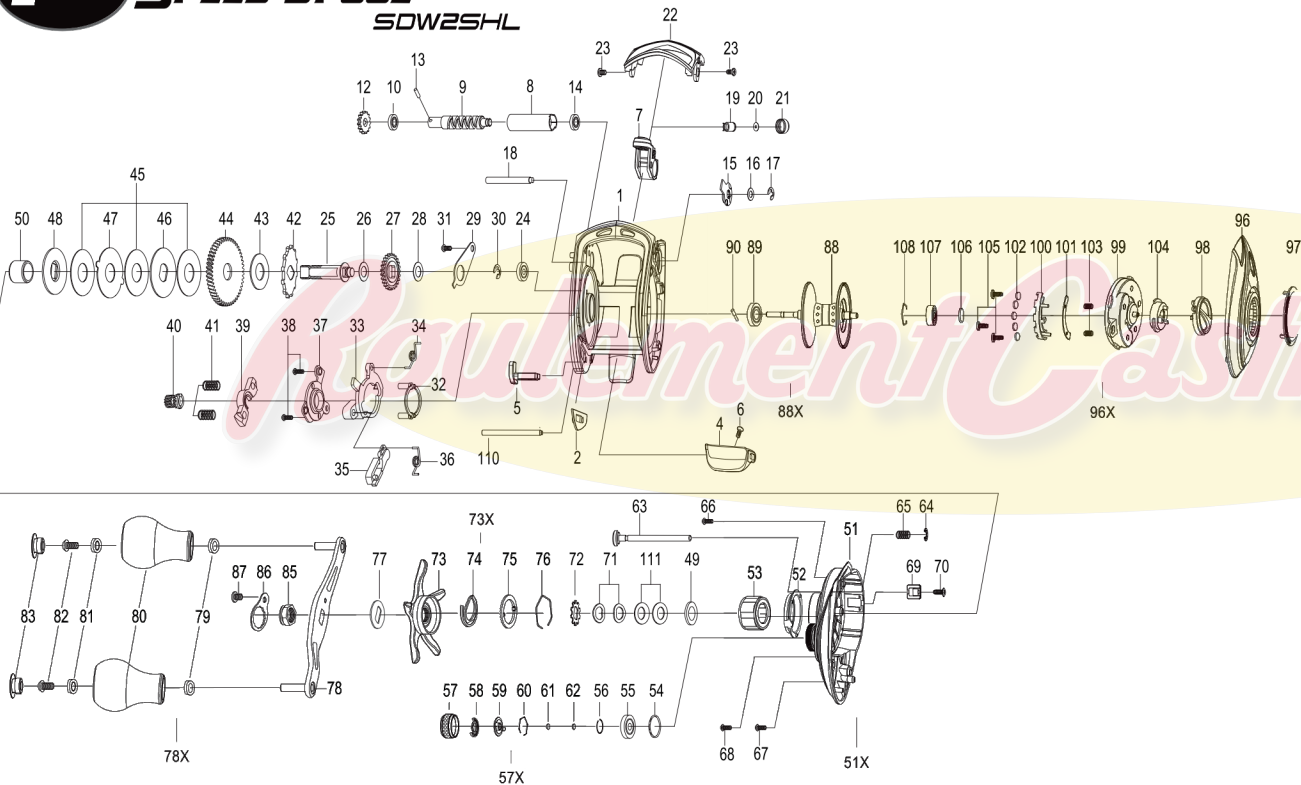

SUPERDUTY WIDE SPEED SPOOL®

SDW2SHL



| KEY # | PART NAME | KEY # | PART NAME | KEY # | PART NAME |
|-------|------------------------|-------|---------------------------|-------|----------------------------|
| 1 | FRAME | 40 | PINION GEAR | 74 | CLICKER |
| 4 | CLUTCH BAR | 41 | PINION YOKE SPRING (2) | 75 | CLICK PLATE |
| 6 | CLUTCH BAR SCREW | 42 | RATCHET | 76 | CLICK PLATE RETAINER |
| 7 | LEVELWIND ASSEMBLY | 43 | RATCHET WASHER | 77 | LEAF SPRING |
| 8 | PIPE | 44 | DRIVE GEAR | 78 | HANDLE |
| 9 | WORM SHAFT | 45 | DRAG WASHER (L-3) | 78X | HANDLE ASSEMBLY |
| 10 | BALL BEARING | 46 | DRAG WASHER (D-1) | 79 | BUSHING |
| 12 | IDLER(S) | 47 | DRAG WASHER (A) | 80 | HANDLE KNOB |
| 13 | WORM SHAFT PIN | 48 | DRAG WASHER (D-2) | 81 | BALL BEARING (2) |
| 15 | WORM SHAFT BUSHING (B) | 49 | SLEEVE WASHER (OPTIONAL) | 82 | HANDLE KNOB SCREW |
| 16 | WORM SHAFT WASHER | 50 | SLEEVE | 83 | HANDLE KNOB CAP |
| 17 | E-RING | 51 | GEAR SIDEPLATE | 85 | HANDLE NUT |
| 18 | PILLAR | 51X | GEAR SIDEPLATE ASSEMBLY | 86 | HANDLE NUT CAP |
| 19 | LEVELWIND PIN | 53 | ONE-WAY CLUTCH BEARING | 87 | SCREW |
| 20 | SPACER (OPTIONAL) | 54 | O-RING | 88 | SPOOL |
| 21 | LEVELWIND NUT | 55 | BALL BEARING | 88X | SPOOL ASSEMBLY |
| 22 | FRONT COVER | 56 | BEARING RETAINER | 89 | BALL BEARING |
| 23 | FRONT COVER SCREW (2) | 57 | CAST CONTROL CAP | 90 | PIN |
| 24 | BALL BEARING | 57X | CAST CONTROL CAP ASSEMBLY | 96 | PALMING SIDEPLATE |
| 25 | CRANK SHAFT | 61 | TENSION WASHER | 96X | PALMING SIDEPLATE ASSEMBLY |
| 26 | IDLER (L) WASHER (A) | 62 | SPOOL SPACER (B) | 97 | PALMING SIDEPLATE TRIM |
| 27 | IDLER (L) | 63 | LOCKING PIN | 98 | CONTROL DIAL |
| 28 | IDLER(L) WASHER (B) | 64 | E-RING | 99 | SPOOL COVER |
| 29 | BEARING PLATE | 65 | LOCKING PIN SPRING | 101 | MAGNET HOLDER PLATE-F |
| 30 | E-RING | 66 | GEAR SIDEPLATE SCREW (A) | 102 | MAGNET (5) |
| 31 | BEARING PLATE SCREW | 67 | GEAR SIDEPLATE SCREW (B) | 103 | MAGNET HOLDER SPRING (2) |
| 33 | CLUTCH CAM | 68 | GEAR SIDEPLATE SCREW (C) | 103 | SLIDE CAM-F |
| 34 | CLUTCH SPRING | 69 | LUBE PORT | 105 | SPOOL COVER SCREW (3) |
| 35 | KICK LEVER | 70 | LUBE PROT SCREW | 106 | SPOOL SPACER-A |
| 36 | KICK LEVER SPRING | 71 | DRAG SPRING WASHER (A-2) | 107 | BALL BEARING |
| 37 | CLUTCH LINK | 72 | DRAG SPACER | 108 | BEARING RETAINER |
| 38 | CLUTCH LINK SCREW | 73 | STAR DRAG | 124 | SLIDE CAM-D |
| 39 | PINION YOKE | 73X | STAR DRAG ASSEMBLY | 125 | CLICK SPRING |