

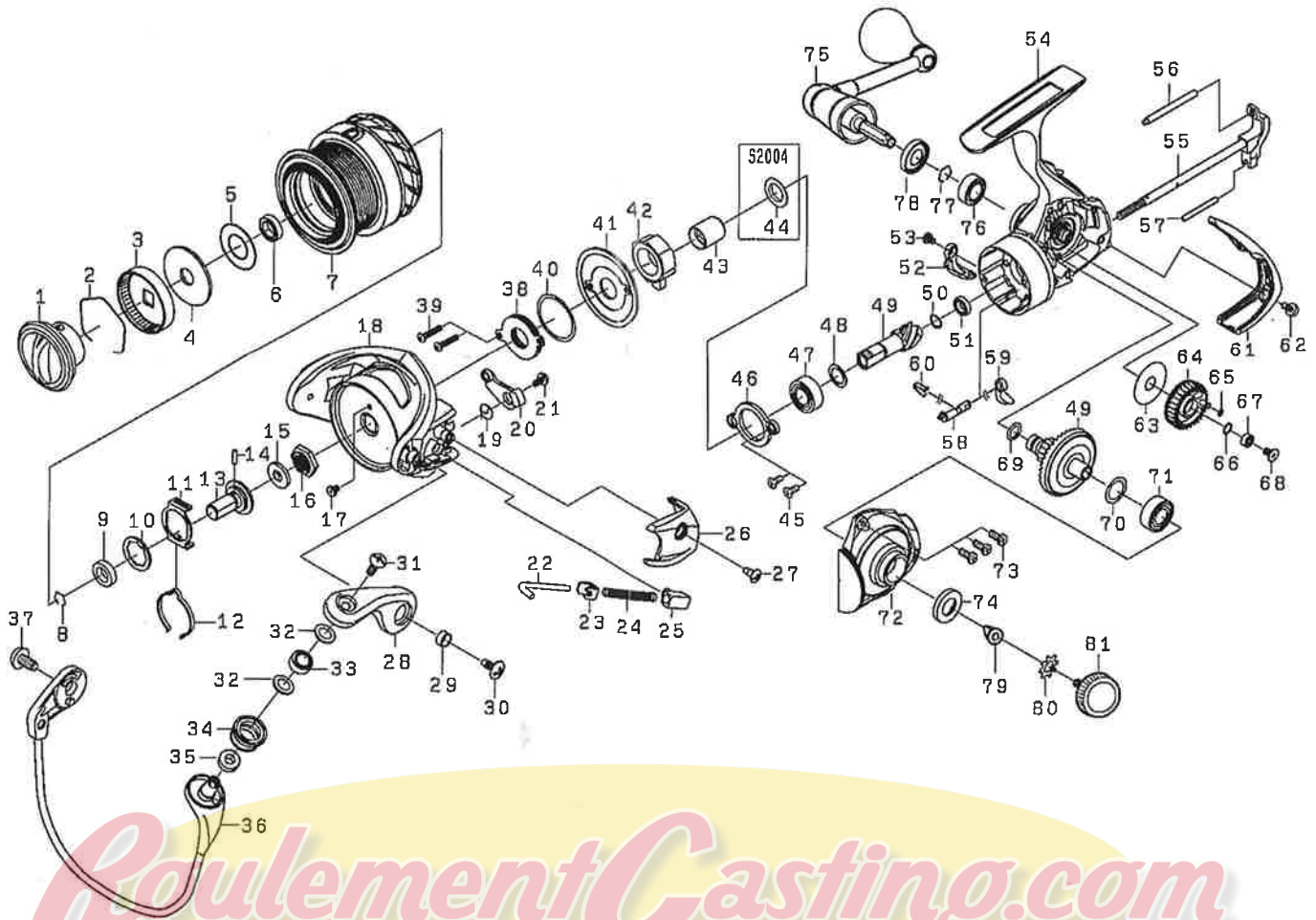

SPINNING REEL



\*Please order by parts number, not key number.

SILVER WOLF S2004/S2506

SILVER WOLF S2004/S2506

Key No.	Parts Name	S2004 Parts No.	S2506 Parts No.	Key No.	Parts Name	S2004 Parts No.	S2506 Parts No.
1	Drag Knob	6J290101	6J290601	42	Roller Clutch	6H412601	6H412601
2	Drag Washer Retainer	6F742501	6F710001	43	Spacing Sleeve	6J001402	6J001402
3	Drag Knob Click Plate	6F908704	6F895307	44	Washer (D)	63758501	—
4	Drag Washer	6H806401	6H806601	45	Screw (H)	6J000901	6J000901
5	Washer (A)	6G025101	6G025001	46	Bearing Retainer (A)	6H442201	6H442201
6	Ball Bearing (A)	6E306801	6E306801	47	Ball Bearing (C)	6G467302	6G467302
2~7	Spool Assembly	6J289801	6J290401	48	Washer (E)	63758500	63758500
8	Collar Retainer	6G472401	6G472401	49	Pinion Gear+Drive Gear	6Z022734	6Z022734
9	Collar (A)	6H624801	6H624801	50	Spring Washer	6H931701	6H931701
10	Washer (B)	6H806300	6H806300	51	Ball Bearing (D)	6H959601	6H959601
11	Click Leaf Spring Holder	6H416001	6H416001	52	Bail Trip Plate	6J022601	6J001101
12	Spool Click Leaf Spring	6H416101	6H416101	53	Screw (I)	6G940402	6G940402
13	Spool Metal	6H717701	6H717701	54	Body	6J289401	6J289401
14	Pin	6G375001	6G375001	55	Main Shaft	6J140601	6J140701
15	Packing (A)	6H986901	6H986901	56	Stabilizer Bar (A)	6H614301	6H614301
16	Rotor Nut	6H961101	6H961101	57	Stabilizer Bar (B)	6J084801	6J084801
17	Screw (A)	6H022701	6H022701	58	Anti-Reverse Cam	6H595501	6H595501
18	Rotor	6H974317	6H960034	59	Anti-Reverse Lever	6H595401	6H595401
19	Bail Trip Lever Spring	6H443301	6H413601	60	Anti-Reverse Cam Spring	6H697801	6H697801
20	Bail Trip Lever	6H443401	6J038501	61	Rear Cover	6J001701	6J001701
21	Screw (B)	6H417701	6H417701	62	Screw (J)	6J001801	6J001801
22	Bail Spring Shaft	6H443601	6H414101	63	Washer (F)	6H595701	6H595701
23	Bail Spring Plate	6H576101	6H576101	64	Oscillating Gear	6H629101	6H595801
24	Bail Spring	6H442401	6H545701	65	"O" Ring (B)	6H770601	6H770601
25	Bail Spring Holder	6H414301	6H414301	66	Washer (G)	6H129200	6H129200
26	Cover (A)	6H974401	6H960201	67	Ball Bearing (E)	6G469005	6G469005
27	Screw (C)	6G270801	6G270801	68	Screw (K)	6G940402	6G940402
28	Bail Arm	6H728905	6H728905	69	"O" Ring (C)	6G670501	6G670501
29	Collar (B)	6H962401	6H962401	70	Washer (H)	63758500	63758500
30	Screw (D)	6G205001	6G205001	71	Ball Bearing (F)	6G467305	6G467305
31	Screw (E)	6G195602	6G195602	72	Side Cover	6J289501	6J289501
32	Washer (C)	6F897101	6F897101	73	Screw (L)	6G332905	6G332905
33	Ball Bearing (B)	6G281601	6G281601	74	Packing (B)	6J100201	6J100201
34	Line Roller	6J089901	6J089901	75	Handle Assembly	6J290601	6J290201
35	Collar (C)	6G874201	6G874201	76	Ball Bearing (G)	6G522701	6G522701
36	Bail Assembly	6J093501	6J096801	77	Bearing Retainer (B)	6G472401	6G472401
37	Screw (F)	6G205001	6G205001	78	Packing (C)	6J100201	6J100201
38	Magnet Assembly	6H532602	6H532602	79	Collar (D)	6F721001	6F721001
39	Screw (G)	6J001601	6J001601	80	Washer (I)	61608401	61608401
40	"O" Ring (A)	6J212501	6J212501	81	Handle Screw	6H613302	6H613302
41	Cover (B)	6J100301	6J100301				