

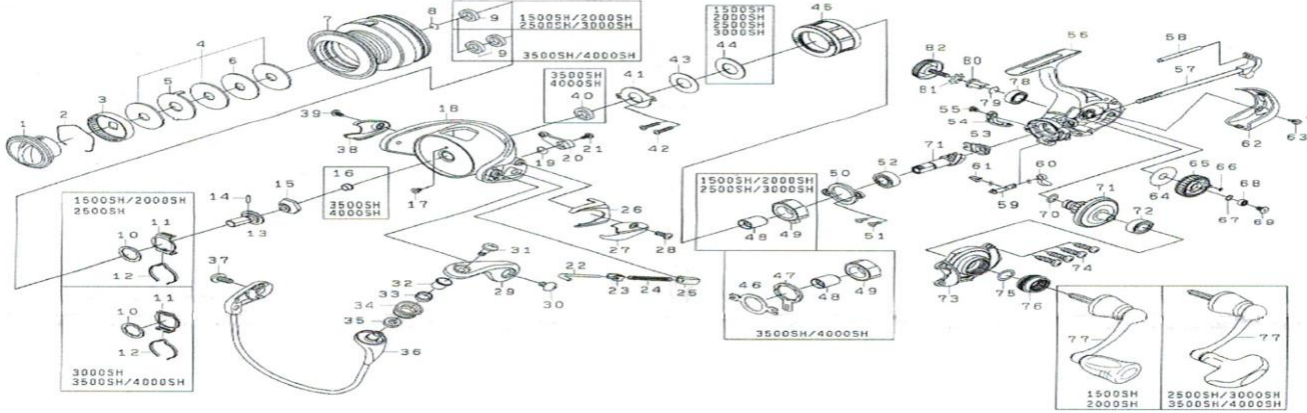

Please order by parts number, not key number
 Veuillez indiquer le numéro de la pièce (Non "Key" No.)

SPINNING REE LEXA1500SH/2000SH/2500SH/3000SH/3500SH/4000SH



Key No.	Parts No.	Parts Name	LEXA 2000SH	LEXA 2500SH	LEXA 3000SH	LEXA 3500SH	LEXA 4000SH
1	H85-9901	DRAG KNOB	H85-9901	H86-0601	H86-0602	H86-1701	H86-1701
2	F74-2501	DRAG WASHER RETAINER	F74-2501	F74-2501	F71-0001	F71-0001	F71-0001
3	F90-8701	DRAG KNOB CLICK PLATE	F90-8701	F90-8701	F89-5301	F89-5302	F89-5302
4	F63-5001	DRAG WASHER	F63-5001	F76-1101	F69-1001	F62-7101	F62-7101
5	F63-5201	EARED WASHER	F63-5201	H76-1301	F75-5701	F75-5701	F75-5701
6	H62-7701	KEY WASHER	H62-7701	H76-1201	H60-9601	H71-4001	H71-4001
2~7	H85-9601	SPOOL ASSEMBLY	H86-0001	H86-0301	H88-4201	H86-1801	H86-1401
8	G47-2401	COLLAR RETAINER	G47-2401	G47-2401	G47-2401	G52-5101	G52-5101
9	H62-4801	COLLAR (A)	H62-4801	H62-4801	H62-4801	G74-7401	G74-7401
10	F62-5500	WASHER (A)	F62-5500	F62-5500	F62-5500	G90-3900	G90-3900
11	H41-6001	CLICK LEAF SPRING HOLDER	H41-6001	H41-6001	H41-6001	G69-4001	G69-4001
12	H88-3701	SPOOL CLICK LEAF SPRING	H88-3701	H88-3701	H88-3701	F70-9002	F70-9002
13	H60-1301	SPOOL METAL	H60-1301	H60-1301	H61-5001	H64-1501	H64-1501
14	G37-5001	PIN	G37-5001	G37-5001	G37-5001	G22-4101	G22-4101
15	H62-9601	ROTOR NUT	H62-9601	H59-8301	H61-4901	H64-1401	H64-1401
16	H02-2701	COLLAR (B)	H02-2701	H02-2701	H02-2701	G75-1201	G75-1201
17	H80-2106	ROTOR	H80-2106	H80-2007	H80-2205	H64-0206	H64-0206
18	H44-3301	BAIL TRIP LEVER SPRING	H44-3301	H41-3601	H41-3601	H41-3601	H41-3601
19	H44-3401	BAIL TRIP LEVER	H44-3401	H41-3701	H46-0301	H64-0401	H64-0401
20	H44-3801	COVER (A)	H44-3801	H41-4801	H46-0501	H64-0902	H64-0902
21	H44-3601	BAIL SPRING SHAFT	H44-3601	H41-4101	H57-2001	H64-0601	H64-0601
22	H57-6101	BAIL SPRING PLATE	H57-6101	H57-6101	H57-6101	H57-6101	H57-6101
23	H44-2401	BAIL SPRING	H44-2401	H54-5701	H41-4201	H64-0701	H64-0701
24	H41-4301	BAIL SPRING HOLDER	H41-4301	H41-4301	H41-4301	H41-4301	H41-4301
25	H44-3707	COVER (C)	H44-3707	H41-4011	H46-0507	H64-0805	H64-0805
26	H44-3801	COVER (A)	H44-3801	H41-4801	H46-0501	H64-0902	H64-0902
28	G27-0801	SCREW (C)	G27-0801	G27-0801	G27-0801	E24-8101	E24-8101
29	H76-8702	BAIL ARM	H76-8702	H76-8702	H72-8902	H72-8902	H72-8902
30	G20-5001	SCREW (D)	G20-5001	G20-5001	G20-5001	B84-2102	B84-2102
31	G19-5602	SCREW (E)	G19-5602	G19-5602	G19-5602	G19-5602	G19-5602
32	G19-5501	COLLAR (C)	G19-5501	G19-5501	G19-5501	G19-5501	G19-5501
33	G22-0701	COLLAR (D)	G22-0701	G22-0701	G22-0701	G22-0701	G22-0701
34	F92-1602	LINE ROLLER	F92-1602	F92-1602	F92-1602	F92-1602	F92-1602
35	G04-7601	COLLAR (E)	G04-7601	G04-7601	G04-7601	G04-7601	G04-7601
36	H76-8802	BAIL ASSEMBLY	H76-8802	H72-8202	H88-3901	H77-3702	H77-3702
37	G20-5001	SCREW (D)	G20-5001	G20-5001	G20-5001	B84-2102	B84-2102
38	H44-4303	COVER (B)	H44-4303	H41-5104	H46-1003	H64-1303	H64-1303
39	G27-0801	SCREW (C)	G27-0801	G27-0801	G27-0801	E24-8101	E24-8101
40	-	COLLAR (F)	-	-	-	H64-0301	H64-0301
41	H60-1101	COVER RETAINER	H60-1101	H60-1101	H60-1101	H64-0001	H64-0001
42	H41-3201	SCREW (F)	H41-3201	H41-3201	H41-3201	H41-3201	H41-3201
43	H60-1001	WASHER (B)	H60-1001	H60-1001	H60-1001	H63-9801	H63-9801
44	H60-0901	WASHER (C)	H60-0901	H60-0901	H60-0901	-	-
45	H60-9305	COVER (D)	H60-9305	H60-9305	H60-9305	H64-2506	H64-2506
46	-	CLUTCH CAM RETAINER	-	-	-	H66-5001	H66-5001
47	-	CLUTCH CAM	-	-	-	F64-1401	F64-1401
48	H61-5501	SPACING SLEEVE	H61-5501	H61-5501	H61-5501	H63-9601	H63-9601
49	H41-2601	ROLLER CLUTCH	H41-2601	H41-2601	H41-2601	G31-4501	G31-4501
50	H44-2201	BEARING RETAINER(A)	H44-2201	H44-2201	H41-1501	H50-9101	H50-9101
51	E13-4509	SCREW (G)	E13-4509	E13-4509	E13-4509	G55-7101	G55-7101
52	G46-7302	BALL BEARING(A)	G46-7302	G46-7302	G46-7302	G53-5104	G53-5104
53	H59-6401	COLLAR (G)	H59-6401	H59-6401	H61-4401	H64-9001	H64-9001
54	H47-9101	BAIL TRIP PLATE	H47-9101	H47-9101	H73-7801	H77-5701	H77-5701
55	H45-5401	SCREW (H)	H45-5401	H45-5401	H45-5401	H45-5401	H45-5401
56	H85-9101	BODY	H85-9101	H85-9101	H88-3401	H85-1001	H85-1001
57	H76-8501	MAIN SHAFT	H76-8501	H76-8501	H73-2701	H77-3301	H77-3301
58	H59-6301	STABILIZER BAR	H59-6301	H59-6301	H61-4301	H63-9301	H63-9301
59	H59-5501	ANTI-REVERSE CAM	H59-5501	H59-5501	H59-5501	H63-9001	H63-9001
60	H59-5401	ANTI-REVERSE LEVER	H59-5401	H59-5401	H59-5401	H59-5401	H59-5401
61	H69-7801	ANTI-REVERSE CAM SPRING	H69-7801	H69-7801	H69-7801	H69-7801	H69-7801
62	H75-7202	REPAIR COVER	H75-7202	H75-7202	H88-3301	H77-3602	H77-3602
63	G33-2704	SCREW (I)	G33-2704	G33-2704	G33-2704	G33-2704	G33-2704
64	H59-5701	WASHER (D)	H59-5701	H59-5701	H59-5701	G64-4201	G64-4201
65	H76-8401	OSCILLATING GEAR	H76-8401	H72-7901	H71-7401	H54-5301	H54-5301
66	H77-0601	"O" RING (A)	H77-0601	H77-0601	G46-6001	B85-3101	B85-3101
67	H12-9200	WASHER (E)	H12-9200	H12-9200	H12-9200	G52-2100	G52-2100
68	G46-9002	BALL BEARING(B)	G46-9002	G46-9002	G46-9002	G46-7102	G46-7102
69	G94-0402	SCREW (J)	G94-0402	G94-0402	G94-0402	H77-8001	H77-8001
70	G67-0501	"O" RING (B)	G67-0501	G67-0501	G67-0501	G64-5301	G64-5301
71	Z02-0737	PINION GEAR+DRIVE GEAR	Z02-0737	Z02-0653	Z02-0692	Z02-0493	Z02-0493
72	G46-7302	BALL BEARING(C)	G46-7302	G46-7302	G46-7302	G52-3401	G52-3401
73	H85-9301	SIDE COVER	H85-9301	H85-9301	H88-3601	H86-1201	H86-1201
74	G33-2904	SCREW (K)	G33-2904	G33-2904	G33-2904	G33-2904	G33-2904
75	G61-3400	WASHER (F)	G61-3400	G61-3400	G61-3400	G64-5600	G64-5600
76	H59-7803	SCREW (L)	H59-7803	H59-7803	H59-7803	H64-5702	H64-5702
77	H85-3401	HANDLE ASSEMBLY	H85-3401	H85-3501	H85-3501	H85-3601	H85-3601
78	G52-2703	BALL BEARING(D)	G52-2703	G52-2703	G52-2703	B86-1704	B86-1704
79	G47-2401	BEARING RETAINER(B)	G47-2401	G47-2401	G47-2401	G52-5101	G52-5101
80	F72-1001	COLLAR (H)	F72-1001	F72-1001	F72-1001	F72-1202	F72-1202
81	160-8101	WASHER (G)	160-8101	160-8101	160-8101	H60-8101	H60-8101
82	H61-3302	HANDLE SCREW	H61-3302	H61-3302	H61-3302	H64-1802	H64-1802