

# DAIWA BAITCASTING REEL

## TTU300HL/HSL/XSL

\*Please order by parts number, not key number.

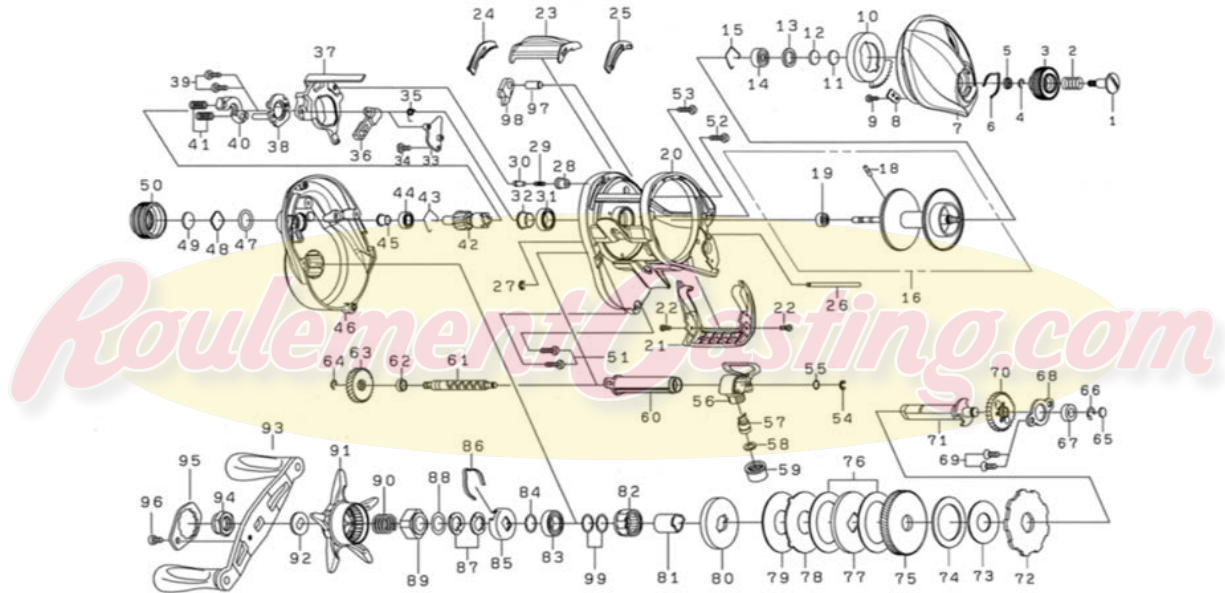

Key No	Part No	Description
1	J71-6301	BRAKE DIAL SCREW
2	E16-7101	BRAKE DIAL SPRING
3	J93-5802	BRAKE DIAL
4	B33-9801	BRAKE DIAL RETAINER(A)
5	F63-7701	BRAKE DIAL COLLAR
6	J93-5901	BRAKE DIAL LEAF SPRING
7	J99-0901	RIGHT SIDE PLATE
8	J94-6901	BRAKE DIAL RETAINER(B)
9	G93-9301	BRAKE DIAL RETAINER(B) SCRERW
10	J97-4501	MAGNET HOLDER
11	375-7404	LS BEARING WASHER (A)
12	375-7411	LS BEARING WASHER (B)
13	G18-5101	LS BEARING WASHER (C)
14	G51-1501	LS BALL BEARING
15	F03-2201	LS BEARING RING
16-19	Z02-5349	SPOOL ASSY (16-19)
18	G71-7501	SPOOL PIN
19	G49-8513	SPOOL BALL BEARING
20	J98-9801	FRAME
21	J93-5501	FRONT COVER
22	H53-1511	FRONT COVER SCREW
23	J93-3101	CLUTCH LEVER
24	J93-2601	CLUTCH LEVER PLATE ( R )
25	J93-2501	CLUTCH LEVER PLATE ( L )
26	J93-5601	OSCILLATING POST
27	H70-4101	OSCILLATING POST RETAINER
28	H91-0601	CLUTCH CAM PLATE PIN SPRING COLLAR
29	H92-8801	CLUTCH CAM PLATE PIN SPRING
30	J05-5201	CLUTCH CAM PLATE PIN
31	G15-6805	CLUTCH CAM BALL BEARING
32	J94-6501	CLUTCH CAM BEARING COLLAR
33	J99-0201	KICK LEVER PLATE ( A )
34	H29-4101	KICK LEVER PLATE ( A ) SCREW
35	J99-0401	KICK LEVER SPRING
36	J99-0301	KICK LEVER
37	J98-9901	CLUTCH CAM PLATE
38	J93-2901	KICK LEVER PLATE ( B )
39	B03-2904	KICK LEVER PLATE ( B ) SCREW
40	M10-6001	CLUTCH PLATE
41	J97-7701	CLUTCH SPRING
42	M12-4501	PINION GEAR
43	H16-0801	PINION RING
44	G46-7102	PINION BALL BEARING
45	J95-3001	PINION BALL BEARING COLLAR
46	J98-9508	LS PLATE
47	B05-5201	ZERO ADJUSTE O-RING
48	J69-2001	ZERO ADJUSTE WASHER (A)
49	B17-5503	ZERO ADJUSTE WASHER (B) 05MM
50	J93-2301	ZERO ADJUSTE KNOB
51	G04-0830	LS PLATE SCREW ( A )
52	G94-5819	LS PLATE SCREW ( B )
53	G04-0832	LS PLATE SCREW ( C )
54	320-5901	WORM SHAFT RETAINER(A)
55	B41-1702	WORM SHAFT WASHER 03MM
56	J97-3801	LEVEL WIND ASSY
57	121-4212	PAWL
58	373-1303	PAWL WASHER 01MM
59	F40-2801	PAWL HOLDER NUT

Key No	Part No	Description
60	J99-0601	WORM SHIELD
61	J93-4101	WORM SHAFT
62	G72-0001	WORM SHAFT COLLAR
63	J93-4201	WORM SHAFT GEAR
65	G09-9801	GEAR SHAFT WASHER03MM
66	320-8002	GEAR SHAFT RETAINER
67	J93-3401	GEAR SHAFT COLLAR
68	M04-0001	GEAR SHAFT PLATE
69	G80-3505	GEAR SHAFT PLATE SCREW
70	J93-3501	WORM GEAR
71	J93-3302	GEAR SHAFT
72	J93-4401	RATCHET
73	H66-1101	DRIVE GEAR WASHER (A)
74	H35-9001	DRIVE GEAR WASHER (B)
75	M12-4601	DRIVE GEAR
76	J93-4701	DRAG WASHER
77	J93-4801	DRAG DISC WASHER (A)
78	J93-4901	DRAG LIP WASHER
79	J97-4301	DRAG DISC WASHER (B)
80	J93-5001	DRAG DISC WASHER (C)
81	J37-7801	DRAG COLLAR
82	G81-9801	ONEWAY CLUTCH
83	G43-1004	HANDLE BALL BEARING
84	B55-3801	HANDLE BEARING WASHER(B)
85	E70-9201	DRAG HOLDER
86	E71-5601	DRAG HOLDER LEAF SPRING
87	150-8901	DRAG SPRING WASHER
88	H92-9501	STAR DRAG WASHER
89	J93-5102	DRAG NUT
90	J01-1901	DRAG NUT SPRING
91	J97-5001	STAR DRAG
92	J10-1302	HANDLE WAHSER
93	J97-4801	HANDLE ASSY
94	J09-0312	HANDLE NUT
95	H28-3605	HANDLE LOCK PLATE
96	H25-7003	HANDLE LOCK PLATE SCREW
97	J94-6701	STOPPER PIN
98	H27-0401	STOPPER ASSY
99	B55-3802	HANDLE BEARING WASHER(A)
200	J97-4901	HANDLE ASSY
201	B41-1703	HANDLE KNOB WASHER
202	J98-8301	HANDLE KNOB
204	G46-9005	HANDLE KNOB BALL BEARING
205	B67-9308	HANDLE KNOB SCREW
206	J99-2201	HANDLE KNOB CAP

### TTU300HSL Special Parts

Key No	Part No	Description
42	M12-3901	PINION GEAR
46	J98-9506	LS PLATE
75	M12-4001	DRIVE GEAR

### TTU300XSL Special Parts

Key No	Part No	Description
42	M12-4101	PINION GEAR
46	J98-9507	LS PLATE
75	M12-4201	DRIVE GEAR